

REVISIONS
 Lot 36814/15 per C Sh 615
 Lot 27/34 per App 638 8-13-34 C Sh 889
 Lot 27/34, 76 & 77 Cond. A. 346 2/17/38 Sh. 1509
 Lot 358, 36 Cond per App 1186 C Sh 4337
 Lot 12, 13 & 64 Thru 71 COND PER APP; 63 PER PLS C SH 9991
 LOT 43 DIV. PER DEED C. SH. 77-121

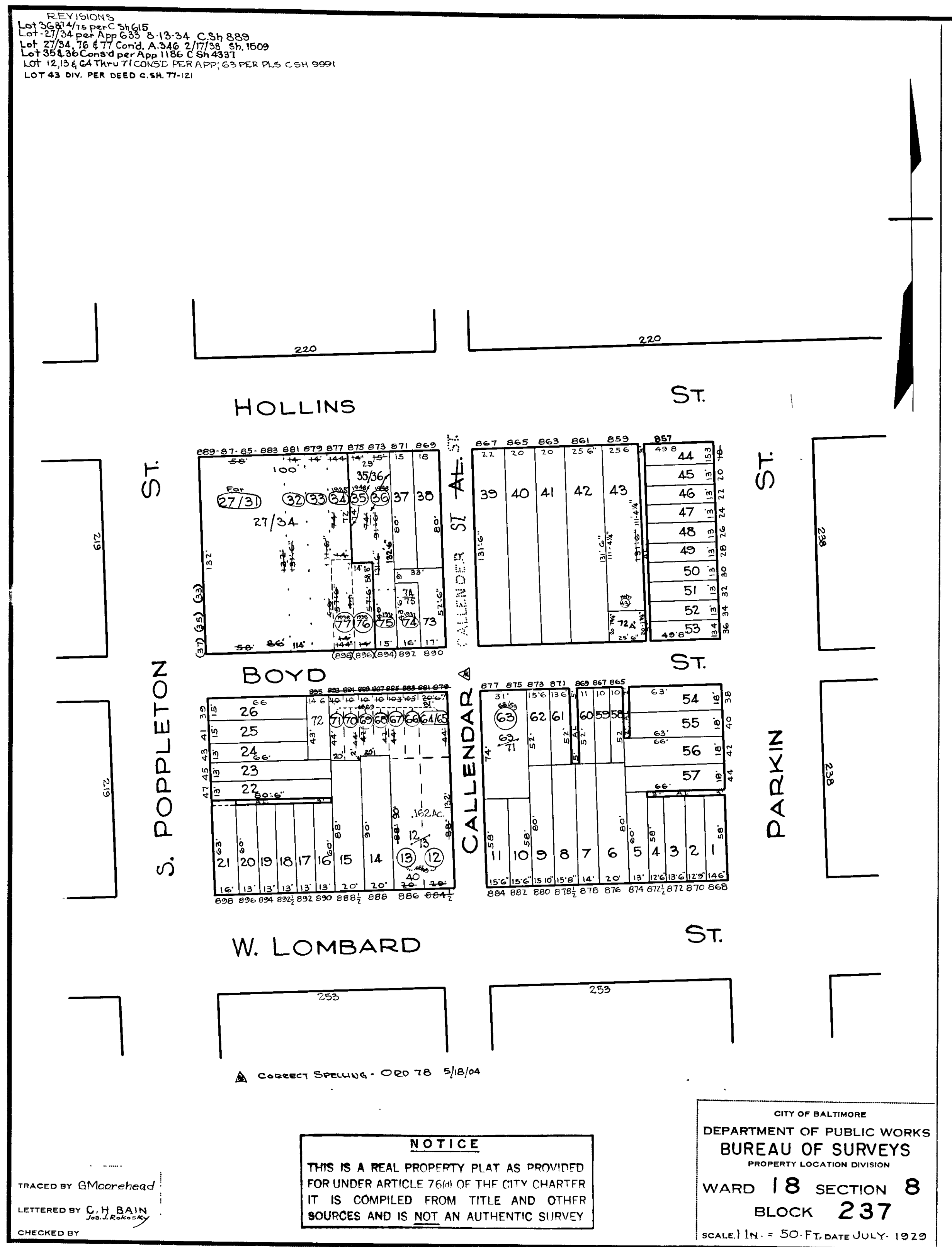

▲ CORRECT SPELLING - ORD 78 5/18/04

NOTICE

THIS IS A REAL PROPERTY PLAT AS PROVIDED
 FOR UNDER ARTICLE 76(d) OF THE CITY CHARTER
 IT IS COMPILED FROM TITLE AND OTHER
 SOURCES AND IS NOT AN AUTHENTIC SURVEY

TRACED BY G Moorehead
 LETTERED BY C. H. BAIN
 Jos. J. Rokoszy
 CHECKED BY

CITY OF BALTIMORE
 DEPARTMENT OF PUBLIC WORKS
 BUREAU OF SURVEYS
 PROPERTY LOCATION DIVISION
 WARD 18 SECTION 8
 BLOCK 237
 SCALE: 1 IN. = 50 FT. DATE JULY, 1929