

W. LAFAYETTE AVE.

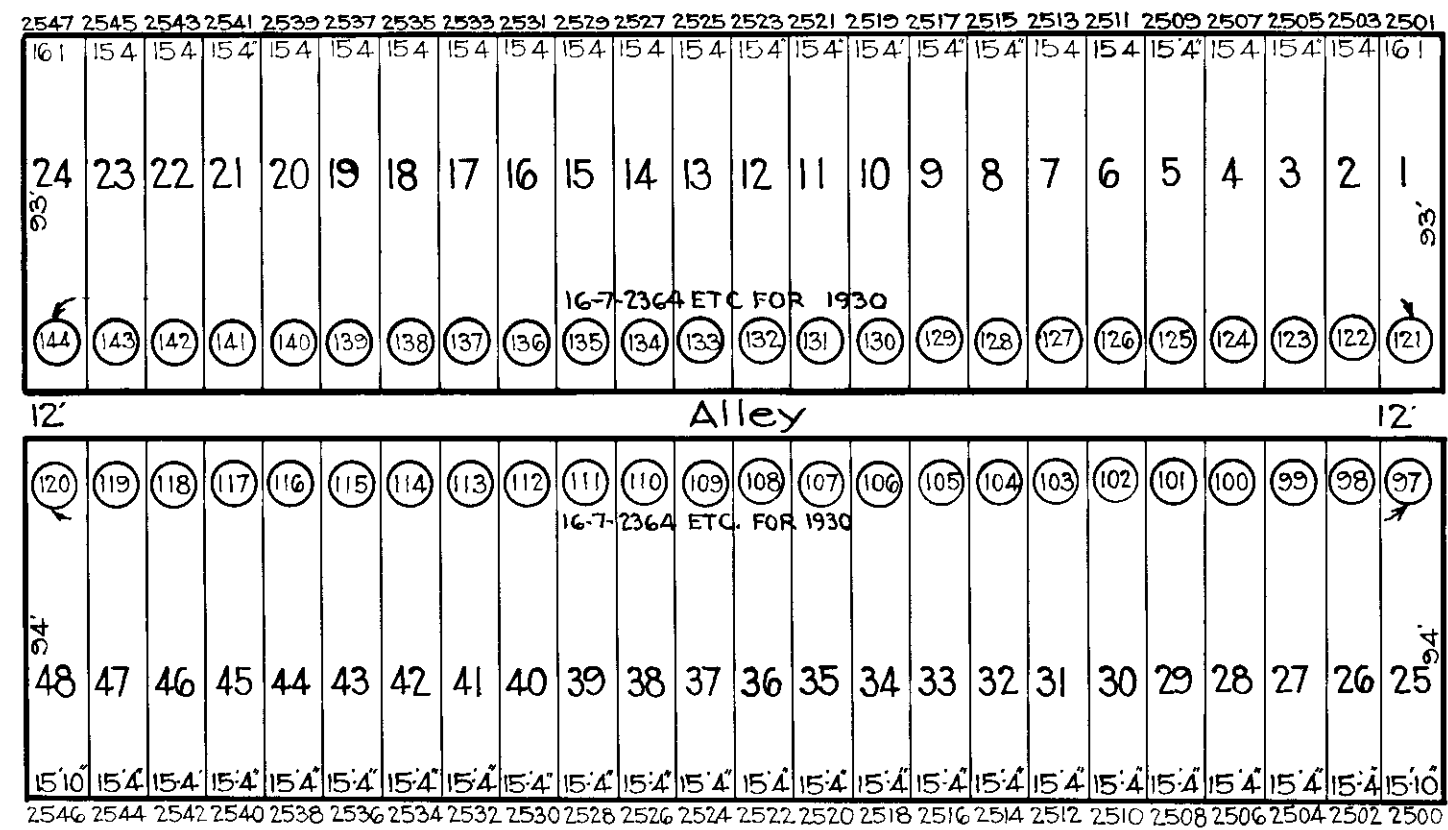

CALVERTON HEIGHTS AVE.

16 - 25 - 2365

100'

Alley

16 - 25 - 2364-A

NOTE - BLOCK 16-7-2364 FOR 1940.

WARWICK AVE.

16 - 25 - 2359 - 59-A

16 - 24 - 2373 - 74

WHITMORE AVE.

**NOTICE**

THIS IS A REAL PROPERTY PLAT AS PROVIDED FOR UNDER ARTICLE 76(1) OF THE CITY CHARTER. IT IS COMPILED FROM TITLE AND OTHER SOURCES AND IS NOT AN AUTHENTIC SURVEY.

CITY OF BALTIMORE  
DEPARTMENT OF PUBLIC WORKS  
BUREAU OF PLANS & SURVEYS  
PROPERTY LOCATION DIVISION

WARD 16 SECTION 25  
BLOCK 2364

SCALE: 1" = 50 FT. DATE Feb. 1930

TRACED BY J.H. Kilmore

LETTERED BY Jos J. Rokosky

CHECKED BY