

REVISIONS

LOT 42/45 Ho. No. Per Field, C.S.H. 8938A

E. OLIVER ST.

ST.

N. CAROLINE ST.

N. CAROLINE ST.

N. DALLAS ST.

N. DALLAS ST.

N. BOND ST.

N. BOND ST.

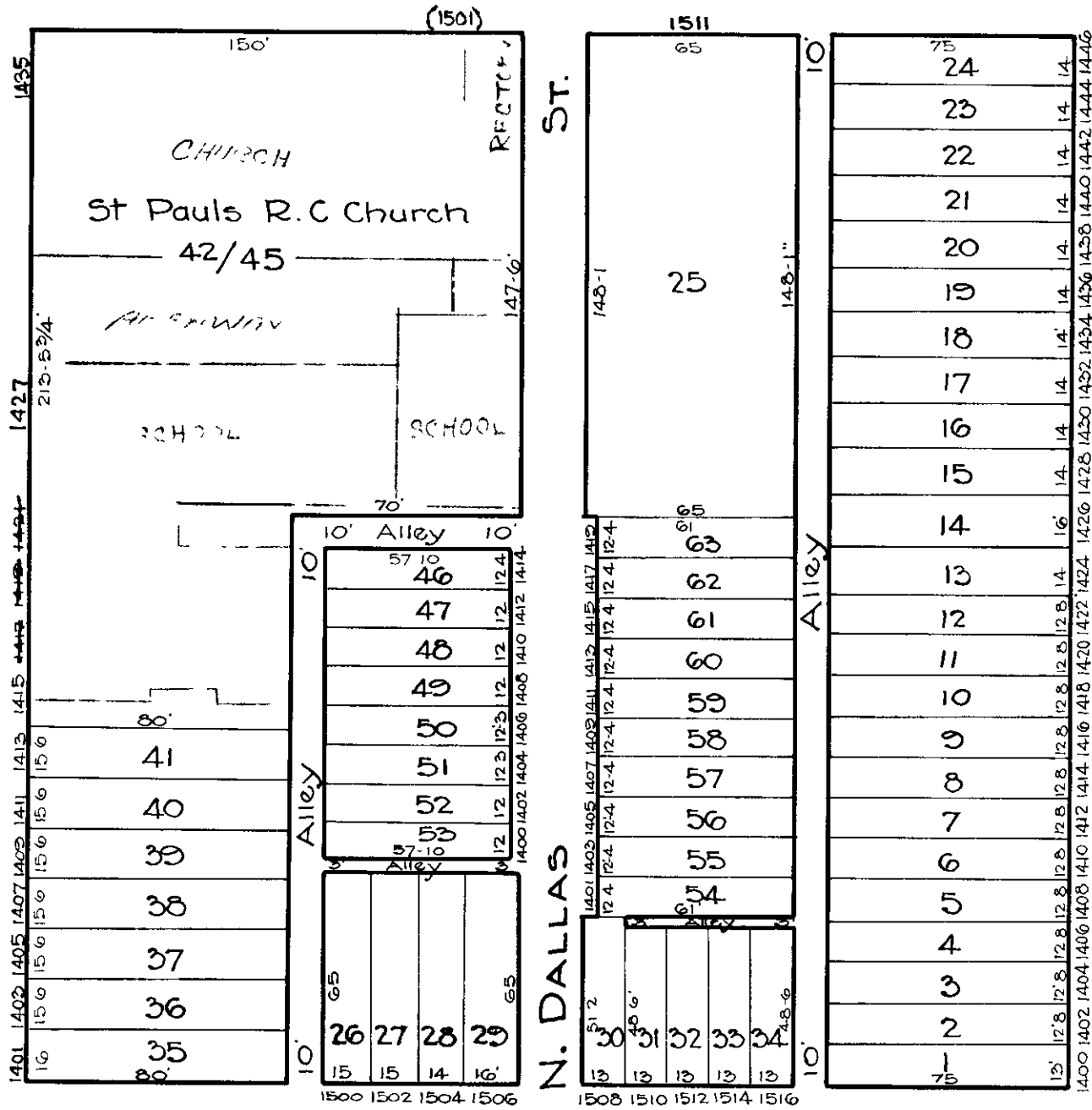

P. B. & W. R.R. with Permission Union R.R.
 E. HOFFMAN (Tunnel) ST.

NOTICE

THIS IS A REAL PROPERTY PLAT AS PROVIDED FOR UNDER ARTICLE 76(H) OF THE CITY CHARTER IT IS COMPILED FROM TITLE AND OTHER SOURCES AND IS NOT AN AUTHENTIC SURVEY

CITY OF BALTIMORE
 DEPARTMENT OF PUBLIC WORKS
 BUREAU OF PLANS & SURVEYS
 PROPERTY LOCATION DIVISION

WARD 8 SECTION 8
 BLOCK 1137

SCALE 1" = 50.0' DATE April 1929

TRACED BY C. H. BAIN

LETTERED BY W. M. Lee

CHECKED BY W. M. Lee
 R. LITZ - G.M.