

REVISIONS
 Lots- 59A, 59B & 60 per Deeds C Sh. 673
 Lot 61/72 Divided (83134) for 1930 C.Sh. 886
 Dim. of Lot 47 Corrected Per Field C.Sh. 1963.
 Lot 59 Divided Per Deed, C.Sh. 4509.
 Lot 60/72 Per App. 1302 C. Sh. 4670
 LOT 81 HO NO CORR, PER, PLS, C SH. 84-196

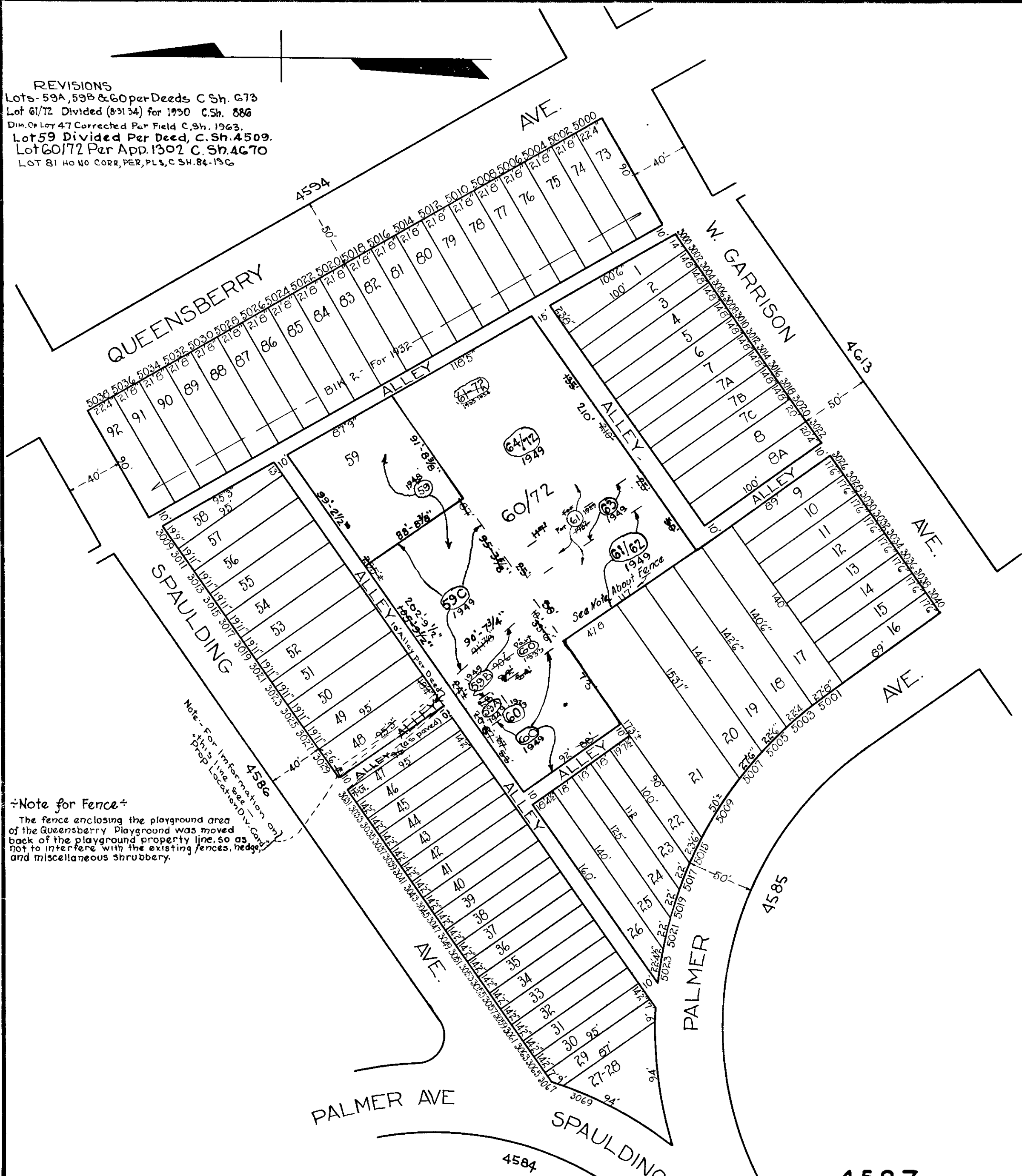

±Note for Fence±
 The fence enclosing the playground area of the Queensberry Playground property was moved back of the playground property line, so as not to interfere with the existing fences, hedge, and miscellaneous shrubbery.

NOTICE
 THIS IS A REAL PROPERTY PLAT AS PROVIDED FOR UNDER ARTICLE 76(d) OF THE CITY CHARTER. IT IS COMPILED FROM TITLE AND OTHER SOURCES AND IS NOT AN AUTHENTIC SURVEY

NOTE: BLOCK 27-19-6 For 1941

TRACED BY *B. Bauersfeld*
 LETTERED BY *B. Bauersfeld*
 CHECKED BY

4587
 CITY OF BALTIMORE
 DEPARTMENT OF PUBLIC WORKS
 BUREAU OF PLANS & SURVEYS
 PROPERTY LOCATION DIVISION
 WARD **27** SECTION **19**
 BLOCK **4587**
 SCALE 1 IN = 60 FT. . DATE DEC. 1931