

REVISIONS
 LOTS 29 & 29A COM'D PER O.O., C. 54. 95

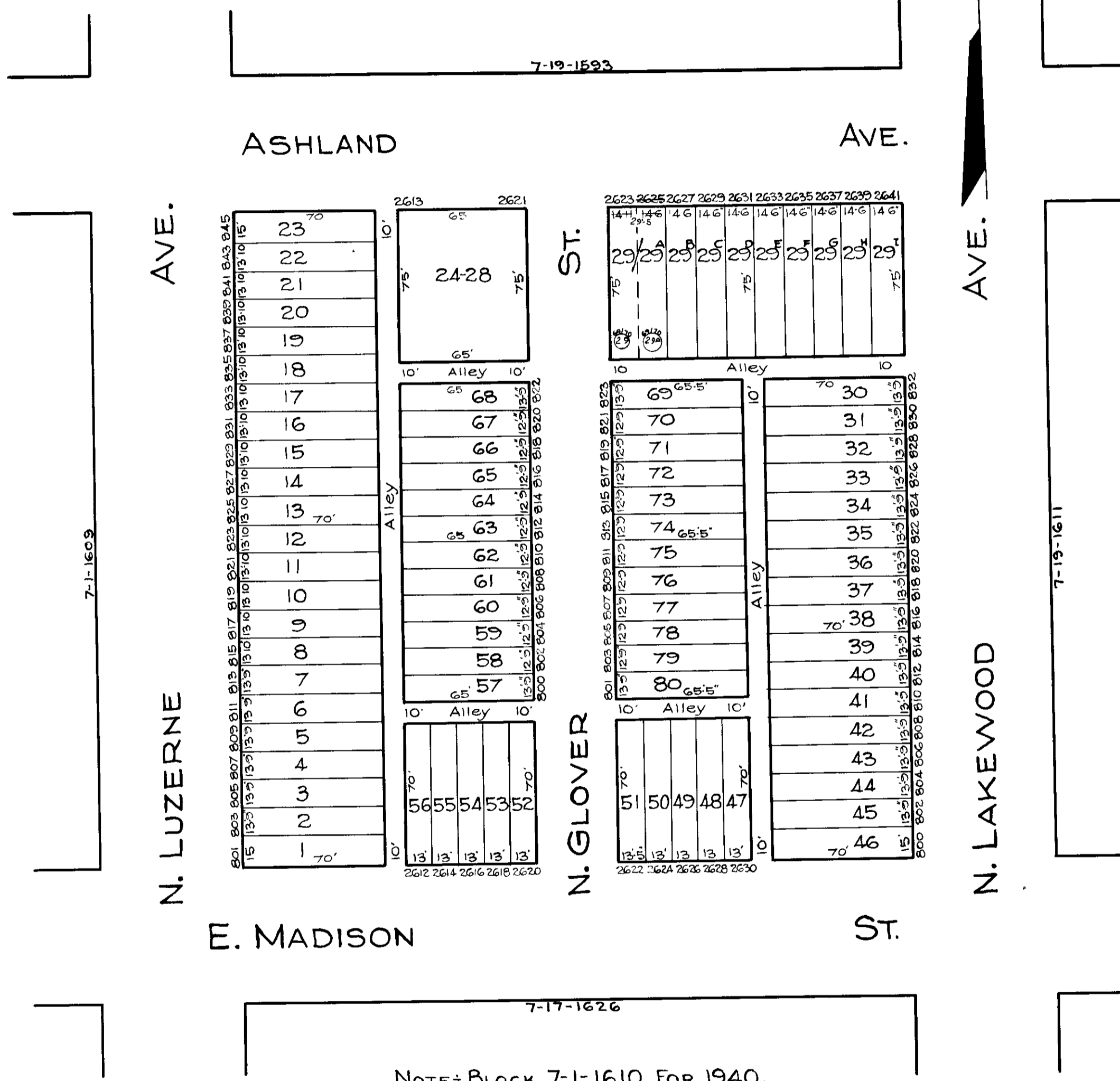

TRACED BY C. GILBERT
 LETTERED BY J. S. Rakosky
 CHECKED BY R. LITZ
 J. B. - BAIN

NOTICE
 THIS IS A REAL PROPERTY PLAT AS PROVIDED FOR UNDER ARTICLE 76(a) OF THE CITY CHARTER. IT IS COMPILED FROM TITLE AND OTHER SOURCES AND IS NOT AN AUTHENTIC SURVEY.

CITY OF BALTIMORE
 DEPARTMENT OF PUBLIC WORKS
 BUREAU OF PLANS & SURVEYS
 PROPERTY LOCATION DIVISION
WARD 7 SECTION 19
BLOCK 1610
 SCALE: 1 INCH = 50 FEET DATE March 1929