

WATER STANDARD NOTES:

- THE CONTRACTOR WILL MAINTAIN, REPAIR, AND/OR REPLACE ANY EXISTING SEDIMENT CONTROL DEVICES ENCOUNTERED AND DISTURBED DURING THE COURSE OF CONSTRUCTION UNDER THIS CONTRACT, AND AS SHOWN ON THE APPROVED SEDIMENT CONTROL PLAN AS PART OF THE CONTRACT DOCUMENTS. AT THE END OF EACH DAY, ALL SUCH DISTURBED DEVICES WILL BE REPAIRED OR REPLACED BEFORE LEAVING THE WORK SITE. THE COST OF PERFORMING THE WORK, INCLUDING MATERIALS, WILL BE PAID FOR BY A LUMP SUM BID FOR MAINTENANCE AND REPAIR OF SEDIMENT CONTROL DEVICES.
- ALL WORK UNDER THIS CONTRACT WILL BE PERFORMED BY THE CONTRACTOR IN ACCORDANCE WITH BALTIMORE COUNTY SOIL CONSERVATION DISTRICT PERMIT NUMBER 281-COUNTY-07 WITH BALTIMORE COUNTY SOIL CONSERVATION DISTRICT PERMIT NUMBER 281-COUNTY-07.
- ALL CONSTRUCTION WILL BE ACCOMPLISHED IN ACCORDANCE WITH BALTIMORE COUNTY STANDARD SPECIFICATIONS AND DETAILS FOR CONSTRUCTION (FEBRUARY 2000, AS AMENDED) AND BALTIMORE CITY STANDARD DETAILS WHERE NOTED.
- UNLESS OTHERWISE NOTED, THE BID LINE FOR EXCAVATION WILL BE SUB-GRADE UNDER PROPOSED ROADS, ESTABLISHED GRADE UNDER TURF AREAS, AND EXISTING GRADE ALONG EXISTING PAVEMENT.
- FULL TRENCH COMPACTION IS REQUIRED FOR A MINIMUM DISTANCE OF 20' ON EACH SIDE OF ALL CROSSINGS, WITHIN ALL EXISTING ROAD RIGHT-OF-WAYS AND WHERE SHOWN ON THE PLANS.
- ONLY BALTIMORE CITY PERSONNEL WILL OPERATE EXISTING VALVES OR NEW VALVES AFTER THEY ARE PLACED IN SERVICE. THE CONTRACTOR WILL NOTIFY THE BALTIMORE COUNTY INSPECTOR TO ARRANGE A SHUTDOWN WITH THE CITY AT LEAST FOUR DAYS PRIOR TO THE PROPOSED SHUTDOWN. IF THE INSPECTOR IN THE FIELD IS UNAVAILABLE, CALL THE BALTIMORE COUNTY AREA ENGINEER AT (410) 887-3551.
- MAIN TO HAVE 4' COVER BASED ON THE ESTABLISHED GRADE UNLESS OTHERWISE NOTED.
- ALL FIRE HYDRANTS WILL BE PLACED 2' BEHIND THE FACE OF CURB. (SEE W-3A)
- VALVES ON FIRE HYDRANT LEADS WILL BE TIED TO THE MAIN LINE TEE OR OUTLET WITH TWO 3/4" DIAMETER THREADED STEEL RODS AND NUTS AS DIRECTED BY THE ENGINEER.
- THE CONTRACTOR WILL DISCHARGE THE CHLORINATED FLUSH WATER INTO A SANITARY SEWER. THE MAXIMUM DISCHARGE RATE WILL BE 80 G.P.M. (COST TO BE INCLUDED IN PRICE OF ITEMS BID).
- THE CONTRACTOR FOR THE MAIN EXTENSION WILL NOTIFY BALTIMORE CITY, BUREAU OF WATER AND WASTEWATER, (410) 346-1663, 72 HOURS BEFORE STARTING WORK.
- THE CONTRACTOR WILL NOTIFY MISS UTILITY AT (800) 257-TTTT AT LEAST 48 HOURS PRIOR TO STARTING EXCAVATION.

- THE SERVICE LEAD WILL BE FLUSHED PRIOR TO METER INSTALLATION
- RESTRAINED JOINTS WILL BE RESTRAINER GLANDS OR MEGALUS OR APPROVED EQUAL
- THE CONTRACTOR WILL DETERMINE THE LOCATION AND DEPTH OF THE EXISTING MAIN BEFORE LAYING ANY PIPE
- ALL TOPS OF MANHOLES, INLETS AND VALVES LOCATED WITHIN THE ROAD METAL SHALL BE BUILT TO AN ELEVATION 0.2' LOWER THAN PROPOSED FINAL GRADE. THIS INTERIM GRADE WILL BE ADJUSTED TO A FINAL GRADE UNDER THE ROAD CONTRACT.
- THE CONTRACTOR SHALL MAINTAIN TRAFFIC AT ALL TIMES.
- TRENCH REPAIR AS PER STANDARD DETAIL R-38.
- FOR ABANDONMENT OF FIRE HYDRANTS, VALVES, MAINS, STUBS, ETC., PLUS THE TEE (BC 84031, 84032), AT THE MAIN, OR THE FITTING MUST BE CUT OUT. ALL FIRE HYDRANTS AND VALVES SHALL BE REMOVED AND RETURNED TO THE UTILITY MAINTENANCE YARD LOCATED AT 2447 WASHINGTON BOULEVARD.
- CONTRACTOR SHALL ENSURE THAT EXISTING VALVE(S) IS TIED BACK BEFORE REMOVING ANY PART OF THE EXISTING WATERLINE OR BUTTRESSES.
- THE CONTRACTOR WILL USE EXTREME CAUTION DURING EXCAVATION AND / OR INSTALLATION OF ALL WORK SHOWN ON THESE PLANS. ALL UTILITIES WILL BE FULLY PROTECTED FROM DAMAGE OR INTERRUPTION. THE DEVELOPER WILL PLACE ROADS TO SUB-GRADE FOR FULL WIDTH OF THE RIGHTS-OF-WAYS BEFORE INSTALLATION OF UTILITIES.

THE COORDINATES, DISTANCES AND ELEVATIONS SHOWN HEREON ARE REFERRED TO THE MARYLAND STATE PLANE SYSTEM (NAD 83/SI & NAVD) AND TIED TO BALTIMORE COUNTY TRAVERSE CONTROL POINTS.

BCO #439A N 619305.20 E 1454165.55 ELEV. 209.17
 BCO #440A N 619325.50 E 1454324.39 ELEV. 244.20

PROFESSIONAL CERTIFICATION, I HEREBY CERTIFY THAT THESE DOCUMENTS WERE PREPARED OR APPROVED BY ME AND THAT I AM A DULY LICENSED PROFESSIONAL ENGINEER UNDER THE LAWS OF THE STATE OF MARYLAND LICENSE NO. 4047 EXPIRATION DATE: 8-31-08

IN MY PROFESSIONAL OPINION THIS PLAN IS SEALED AND CERTIFIED THAT THE RIGHT OF WAY AND EASEMENTS SHOWN HEREON CONFORM IN ALL MATERIAL RESPECTS TO THE RIGHT OF WAY EASEMENTS SHOWN ON THE RECORDS OF BALTIMORE COUNTY IN PLAT BOOK 10110, WHICH PLAT WAS PREPARED IN COMPLIANCE WITH BALTIMORE COUNTY DEPARTMENT PERMITS AND DEVELOPMENT MANAGEMENT, BUREAU OF LAND ACQUISITION, DRAFTING SECTION MANUAL DATED JAN. 1997.

NOTE: WATER LINE STATIONS SEE DWG 56-445 FITCH AVE. CLOSE TO V. STA. 0+33 FROM BELAIR RD.

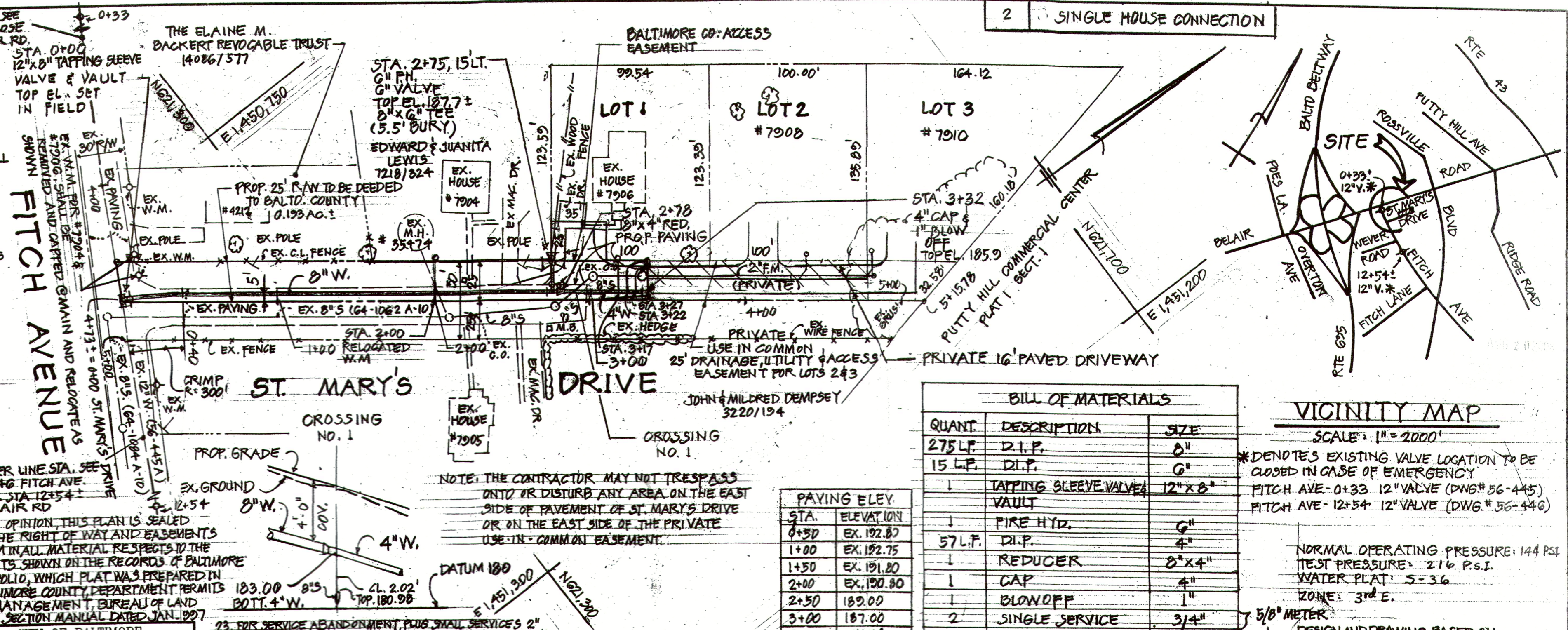

PAVING ELEV.

STA.	ELEVATION
0+50	EX. 192.80
1+00	EX. 192.75
1+50	EX. 191.80
2+00	EX. 190.80
2+50	189.00
3+00	187.00
3+35.26	185.70

BILL OF MATERIALS

QUANT.	DESCRIPTION	SIZE
275 LF.	D.I.P.	8"
15 LF.	D.I.P.	6"
1	TAPPING SLEEVE VALVE & VAULT	12" x 8"
1	FIRE HYD.	6"
57 LF.	D.I.P.	4"
1	REDUCER	8" x 4"
1	CAP	4"
1	BLOWOFF	1"
2	SINGLE SERVICE	3/4"
110 LF.	COPPER PIPE	3/4"
2	RELOCATED SINGLE SERVICE	3/4"
1	TEE	8" x 6"
1	VALVE & VAULT	6"

VICINITY MAP
 SCALE: 1" = 2000'

* DENOTES EXISTING VALVE LOCATION TO BE CLOSED IN CASE OF EMERGENCY
 FITCH AVE - 0+33 12" VALVE (DWG # 56-445)
 FITCH AVE - 12+54 12" VALVE (DWG # 56-446)

NORMAL OPERATING PRESSURE: 144 PSI
 TEST PRESSURE: 216 P.S.I.
 WATER PLAT: S-36
 ZONE: 3RD E.
 5/8" METER

DESIGN AND DRAWING BASED ON MARYLAND COORDINATE SYSTEM NAD 83/SI HORIZONTAL AND NAVD 1988 VERTICAL DATUM AND BCMD

REVISION - CITY OF BALTIMORE

DATE: 6/12/08	DATE: 6/13/08	DATE: 6/13/08
BY: [Signature]	BY: [Signature]	BY: [Signature]
POSITION: CHIEF, UTILITY ENGINEERING	POSITION: CHIEF, WATER ENGINEERING SECTION	POSITION: DIRECTOR
DEPARTMENT: DEPT. OF PUBLIC WORKS	DEPARTMENT: DEPT. OF PUBLIC WORKS	DEPARTMENT: DEPT. OF ENGINEERING & CONSTRUCTION
PLAN: 1" = 50'	APPROVED: [Signature]	DATE: 6/3/08
PROFILE: 1" = 50' HORIZ. / 1" = 5' VERT.	DATE: 6/3/08	DATE: 5/30/08
AS-BUILT PER RECORD PRINT	REVISION	DATE
DRAFTSMAN: [Signature]	DATE: [Blank]	DATE: [Blank]
ENGINEER: [Signature]	DATE: [Blank]	DATE: [Blank]
CHKD BY: P.L.	DATE: [Blank]	DATE: [Blank]

23. FOR SERVICE ABANDONMENT PLUS SMALL SERVICES 2" OR LESS AT THE CURB ON THE MAIN LARGE SERVICES SHALL BE PLUGGED AT THE TEE ON THE MAIN (BC 89031, 89032) OR THE FITTING MUST BE CUT OUT. METERS SHALL BE RETURNED TO THE METER SHOP AT 200 N. FRANKLIN TOWN ROAD. ADDRESS SHALL NOT BE RELOCATED WITHOUT PERMISSION FROM BALTO. CITY, BUREAU OF WATER AND WASTE WATER.

24. METERS DESIGNATED TO A SPECIFIC LOCATION OR ADDRESS SHALL NOT BE RELOCATED WITHOUT PERMISSION FROM BALTO. CITY, BUREAU OF WATER AND WASTE WATER.

CW0.51254

BALTIMORE COUNTY DEPARTMENT OF PUBLIC WORKS BUREAU OF ENGINEERING & CONSTRUCTION RECEIVED

8" AND 4" WATER MAIN - ST. MARY'S DRIVE
 FROM INTERSECTION OF FITCH AVE. NORTHEASTERLY ALONG ST. MARY'S DRIVE 340'

SUBDIVISION: 543 PROPERTIES

ELECT. DISTRICT NO. 1406



SHEET DESIGNATION	CONTRACT NO.
JOB ORDER NO.	203-0111-1969
SHEET 1 OF 1	DRAWING NO.
2007-3096	FILE NO. 3