

REVISIONS
 Lot 106 Div. Per Deed & P.L.D. C.S.H. 7947.
 Lot 82/85 Div. Per Mc CONROY & P.L.D. C.S.H. 8399.
 Lot 4/85 Div. Per LETTER C.S.H. 9063
 Lot 84 Div. Per R.W. Div. & P.L.D. C.S.H. 9293
 Lot 106/106A Cons'd. Per App. C.S.H. 9871
 Lot 106 Per. App. C.S.H. 16-324
 Lot 86 No. Ho. Per P.L.S. C.S.H. 79-009A
 Lots 35A, 35B, 87 thru 91, 91A, & 106 Per Deed, Sur.,
 & P.L.S. C.S.H. 85-423-424.
 Lots 87-91 Div. Per Sub. Div. C.S.H. 95-125
 Pt. of Lot 86/91 to P.S.C. Acc. C.S.H. 95-152
 Lot 105 Add. Per C.O. C.S.H. 02-037
 Lot 86/91 Pt. To MTA R/W Per Deed C.S.H. 83-234

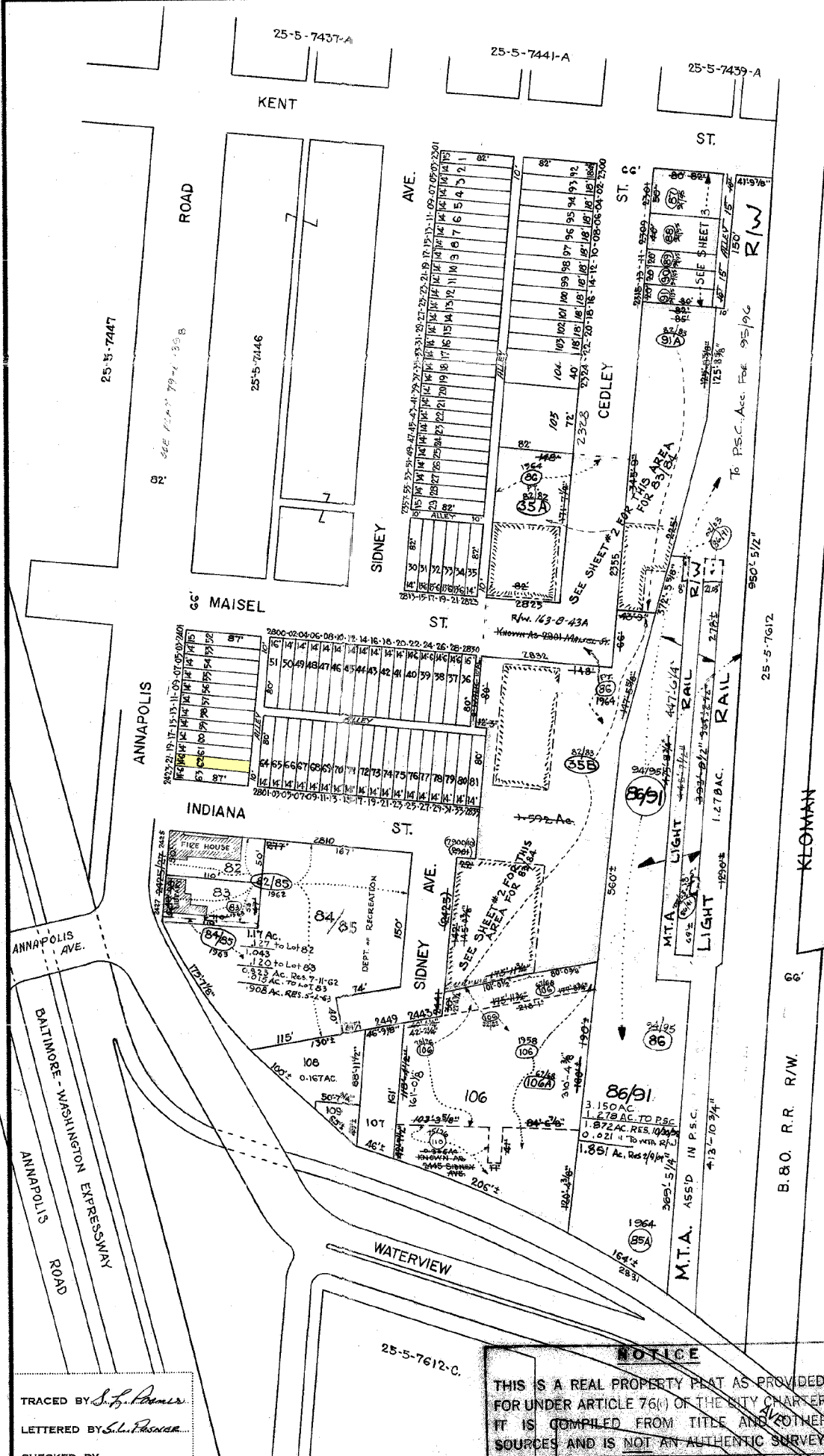

25-5-7612

664 Lot 35B
 Lot 86 2.399 Ac.
 1.484 " ST BED.
 1.512 " TO LOT 85A
 1.592 " RES. 7-28-84

THIS ACREAGE VOID FOR 83/84 SEE SHEET 2.

ACREAGE - Lot 106
 0.755 Ac.
 0.172 " FR. Lot 106
 0.875 Ac. RES. 2-13-83.
 0.365 " FR. Lot 106
 1.180 Ac. RES. 4-6-76
 1.163 Ac. COR. 4-20-83
 0.008 " TO Lot 85C FOR 83/84
 1.160 Ac. RES. 4-20-83.

25-5-7611

SHEETS IN SET-3
 SHEET NO. 1.

REF: 163-B-43A
 79-A-59B & F.D. 55.

CITY OF BALTIMORE
 DEPARTMENT OF PUBLIC WORKS
 BUREAU OF SURVEYS
 PROPERTY LOCATION DIVISION
 WARD 25 SECTION 5
 BLOCK 7445
 SCALE: 1" = 100' DATE: Jan. 1960

NOTICE
 THIS IS A REAL PROPERTY PLAT AS PROVIDED FOR UNDER ARTICLE 76(1) OF THE CITY CHARTER. IT IS COMPILED FROM TITLE AND OTHER SOURCES AND IS NOT AN AUTHENTIC SURVEY.

TRACED BY *S.L. Pomeroy*
 LETTERED BY *S.L. Pomeroy*
 CHECKED BY _____