

REVISIONS  
 Lot 4A to bed of Alley for 1934 etc. C Sh. 796.  
 " 19, 20 per Decd. C.O.S. C. Sh. 1345.  
 Lots 14 to 16 & 19 to 23 Per P.S. C. Sh. 2372  
 " 17 to 19, Cons'd. Per App. 4209, C. Sh. 2392.  
 Lot 26/27 Per App. C. Sh. 3945  
 Lots 40 & 41 ST No Ch. C. Sh. 5899A

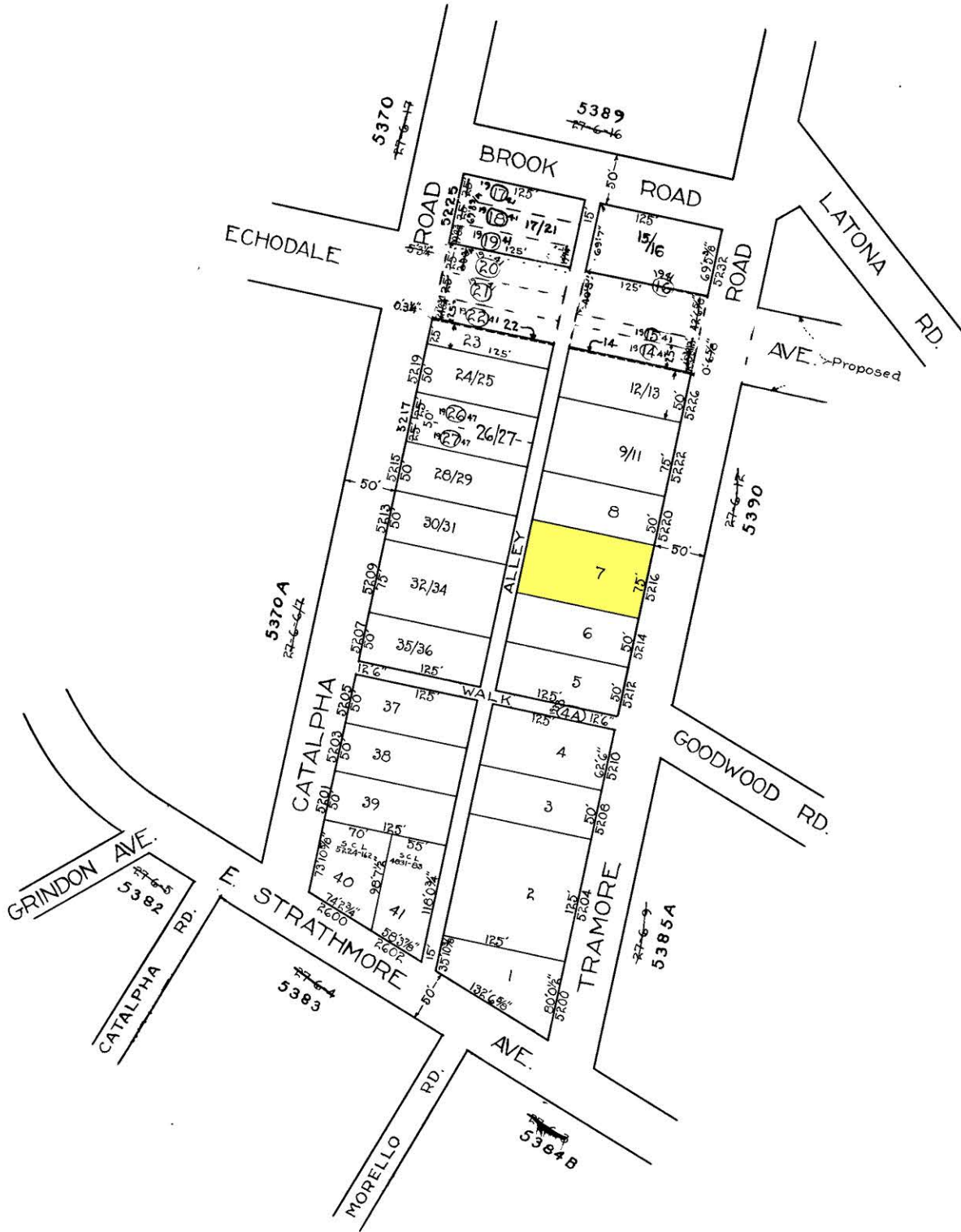

**NOTICE**  
 THIS IS A REAL PROPERTY PLAT AS PROVIDED FOR UNDER ARTICLE 76(d) OF THE CITY CHARTER. IT IS COMPILED FROM TITLE AND OTHER SOURCES AND IS NOT AN AUTHENTIC SURVEY.

**5386**  
 CITY OF BALTIMORE  
 DEPARTMENT OF PUBLIC WORKS  
 BUREAU OF PLANS & SURVEYS  
 PROPERTY LOCATION DIVISION  
 WARD...27 SECTION 6  
 BLOCK 5386  
 SCALE 1 IN. = 100 FT., DATE APRIL 1932

NOTE: BLOCK 27-6-10 For 1941

TRACED BY *S. Bauersfeld*  
 LETTERED BY *S. Bauersfeld*  
 CHECKED BY