

**REVISIONS**

LOTS 18-20/21 CONSD PER O.C.S.H. 90-174  
 LOTS 10 & 11 CONSD PER O.C.S.H. 91-323  
 LOT 12 ADD. CH. PER B.A./CH. SH. 04-012

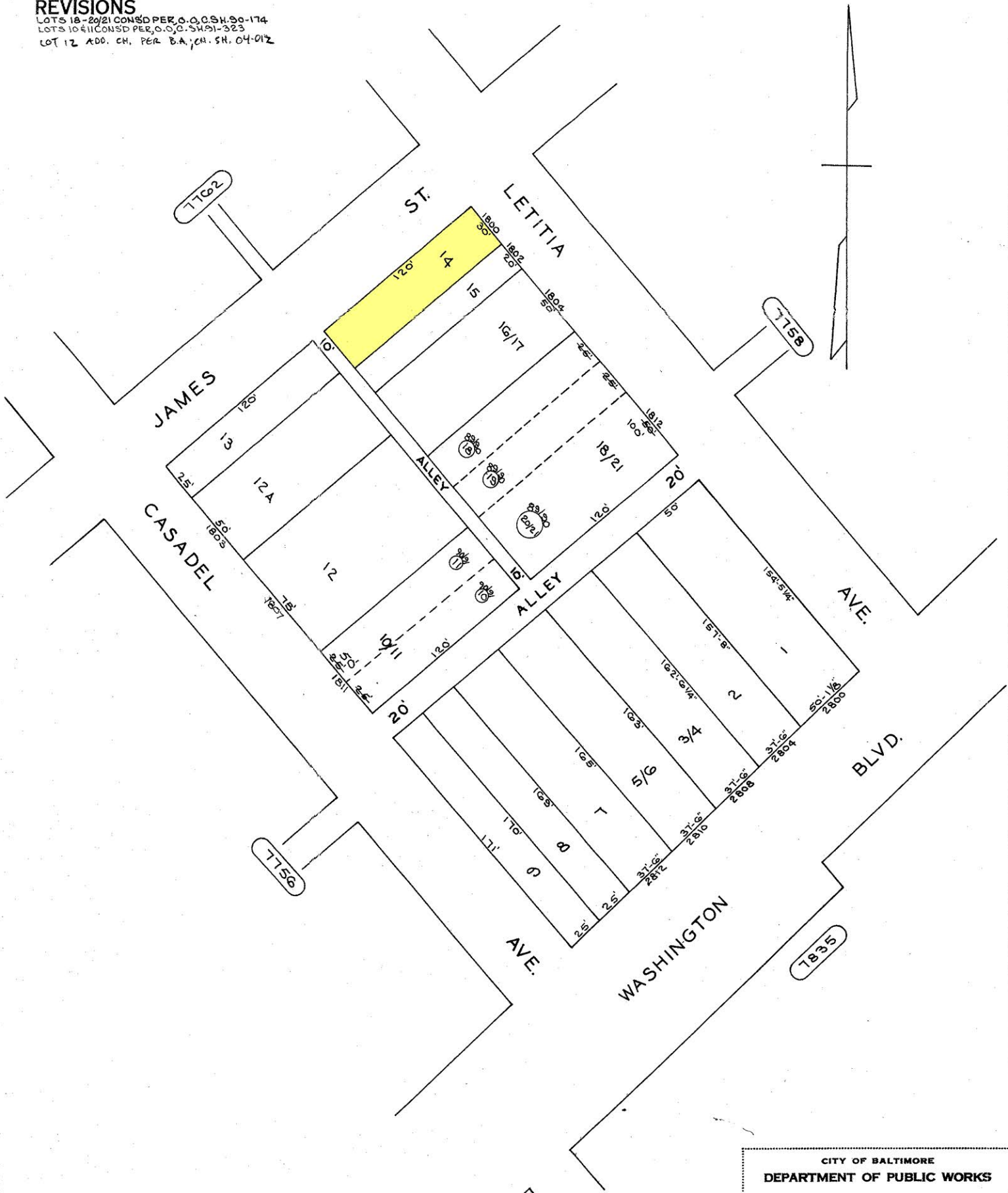

TRACED BY D.G.  
 LETTERED BY D.G.  
 CHECKED BY \_\_\_\_\_

**NOTICE**  
 THIS IS A REAL PROPERTY PLAT AS PROVIDED FOR UNDER ARTICLE 76(d) OF THE CITY CHARTER IT IS COMPILED FROM TITLE AND OTHER SOURCES AND IS NOT AN AUTHENTIC SURVEY.

CITY OF BALTIMORE  
 DEPARTMENT OF PUBLIC WORKS  
 PROPERTY LOCATION SECTION  
 WARD **25** SECTION **2**  
 BLOCK **7757**  
 SCALE: 1"=50' DATE JAN 1990