

REVISIONS

LOT 50-54 DIVIDED FOR 1936 Per App. No. 290/94 C. Sh. 952.
 Lots 55/59-70/86 Per P.L.D. C. Sh. 6802

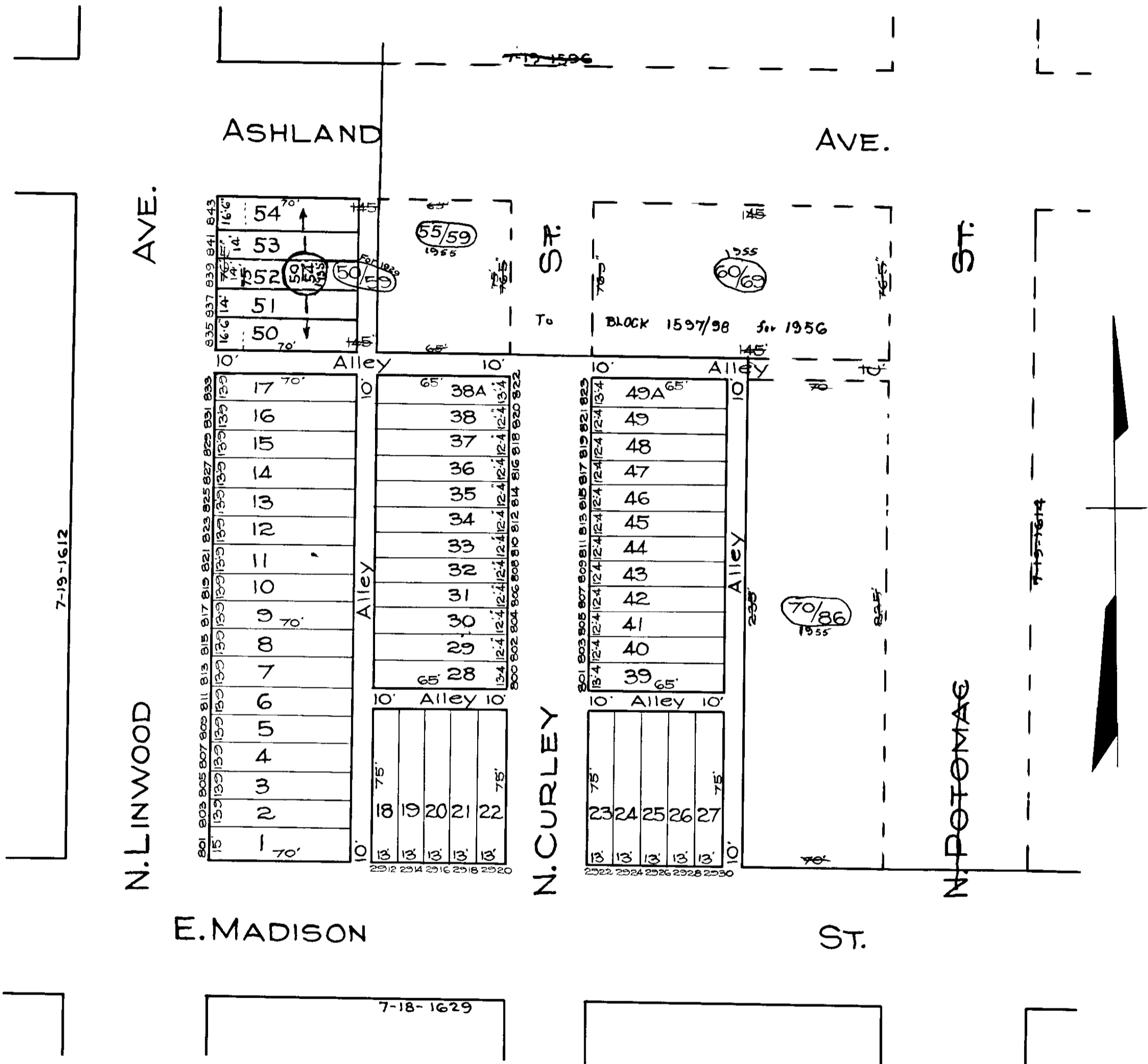

7-19-1612

N. LINWOOD

E. MADISON

N. CURLEY

ST.

N. POTOMAC

7-18-1629

NOTE: BLOCK 7-1-1613 FOR 1940.

C. H. BAIN
 TRACED BY C. GILBERT
 LETTERED BY Jos. J. Rokosky
 CHECKED BY R. LITZ
 J. R. BAIN

NOTICE
 THIS IS A REAL PROPERTY PLAT AS PROVIDED FOR UNDER ARTICLE 76(4) OF THE CITY CHARTER. IT IS COMPILED FROM TITLE AND OTHER SOURCES AND IS NOT AN AUTHENTIC SURVEY.

CITY OF BALTIMORE
 DEPARTMENT OF PUBLIC WORKS
 BUREAU OF PLANS & SURVEYS
 PROPERTY LOCATION DIVISION
 WARD 7 SECTION 19
 BLOCK 1613
 SCALE 1/4" = 50 FT. DATE April 1929