

REVISIONS

LOT 4 DIVIDED PER APP 3057, DEEDS, SURVEY & O. O. C. SH. 1458.
 LOTS 4K-4Q PER APP. 1528/32. LOTS 5, 12 PER D.P. C. SH. 1728.
 LOT 5 DIVIDED PER APP. 367/369 C. SH. (3758 VOID) 3950.
 LOTS 1 & 2 PER APP. & LEASE C. SH. 8603
 LOTS 1 & 2 COND. PER D.P. C. SH. 8647
 LOTS 3 & 4 PER DEED & P.L.S.; C. SH. 77-023.

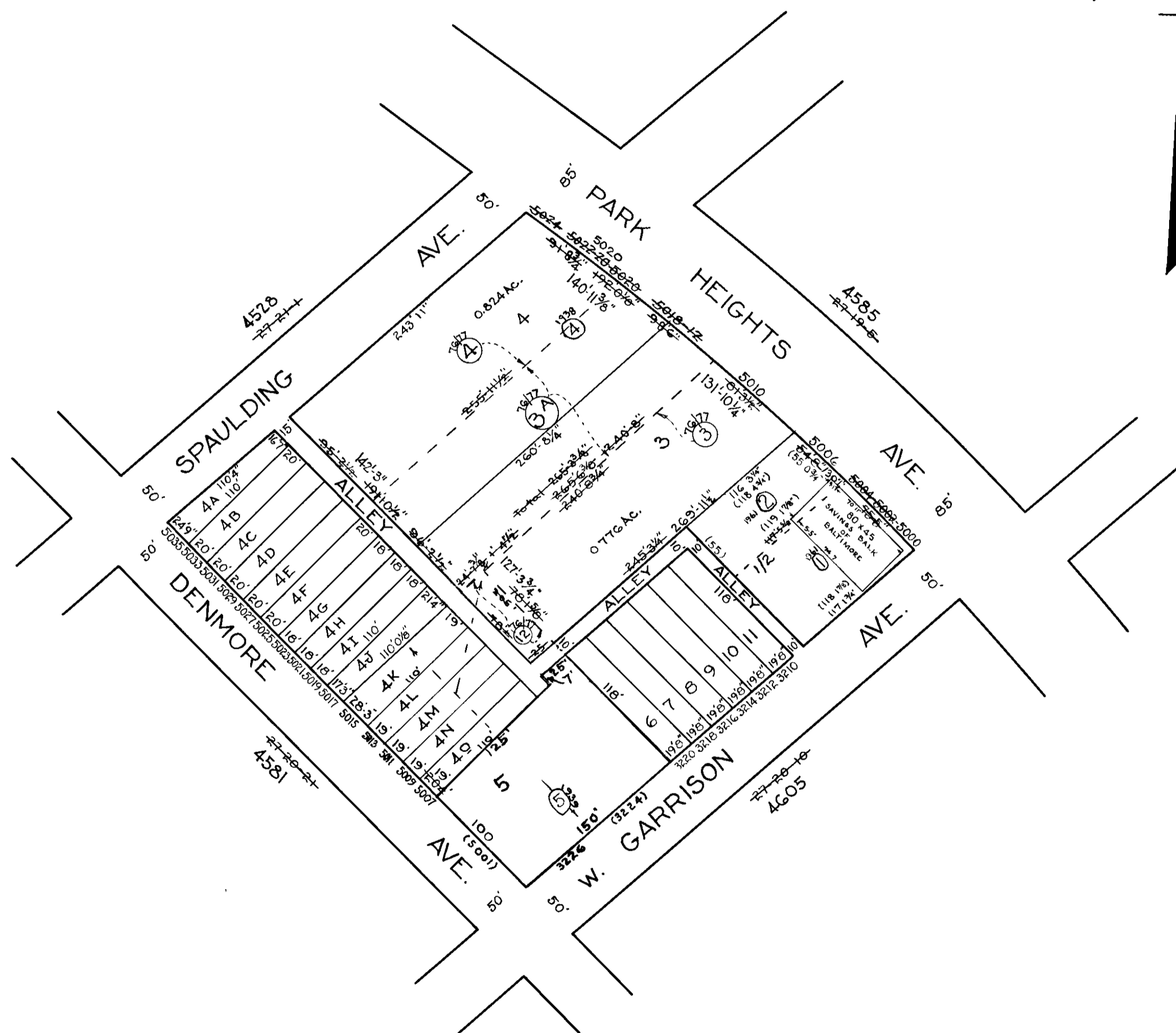
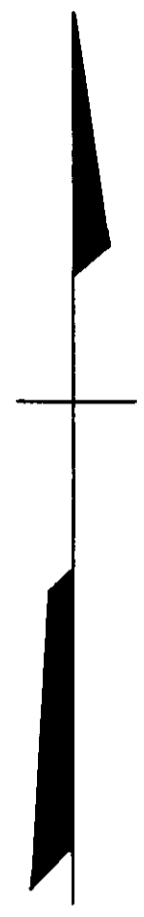

NOTICE
 THIS IS A REAL PROPERTY PLAT AS PROVIDED
 FOR UNDER ARTICLE 76(4) OF THE CITY CHARTER.
 IT IS COMPILED FROM TITLE AND OTHER
 SOURCES AND IS NOT AN AUTHENTIC SURVEY

NOTE ÷ BLOCK 27-20-20 FOR 1941.

TRACED BY *S. Bauserfeld*
 LETTERED BY *S. Bauserfeld*
 CHECKED BY

4583
 CITY OF BALTIMORE
 DEPARTMENT OF PUBLIC WORKS
 BUREAU OF PLANS & SURVEYS
 PROPERTY LOCATION DIVISION
 WARD **27** SECTION **20**
 BLOCK **4583**
 SCALE 1 IN. = 80 FT., DATE SEPT 1931