

REVISIONS

LOTS 12/13 DIV. PER. DEED C.S.H. 9839

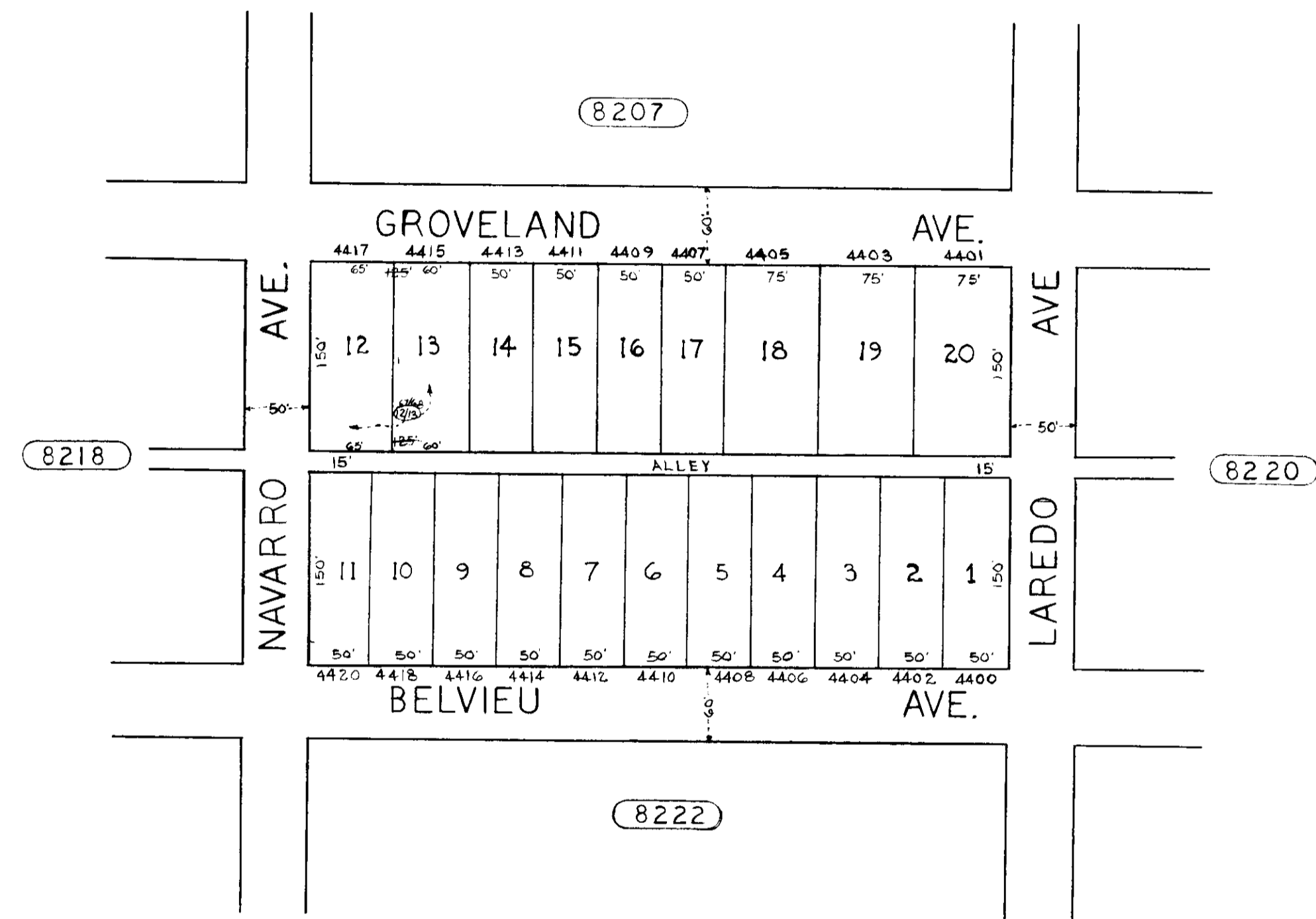

TRACED BY C.T. WOODHOUSE, JR.
LETTERED BY C.T. WOODHOUSE, JR.
CHECKED BY

NOTICE
THIS IS A REAL PROPERTY PLAT AS PROVIDED FOR UNDER ARTICLE 76(d) OF THE CITY CHARTER IT IS COMPILED FROM TITLE AND OTHER SOURCES AND IS NOT AN AUTHENTIC SURVEY.

CITY OF BALTIMORE
DEPARTMENT OF PUBLIC WORKS
PROPERTY LOCATION DIVISION
WARD **28** SECTION **2**
BLOCK **8219**
SCALE 1" = 50' DATE NOV. 1967