

REVISIONS
 Lot 29A Ho.No. Changed Per. O.O. C. Sh. 5577 A
 Lots 25 THRU 28 CONS'D PER APP C.S.H. 85-192

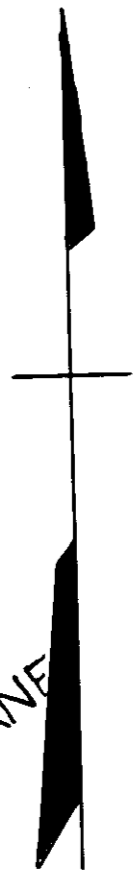
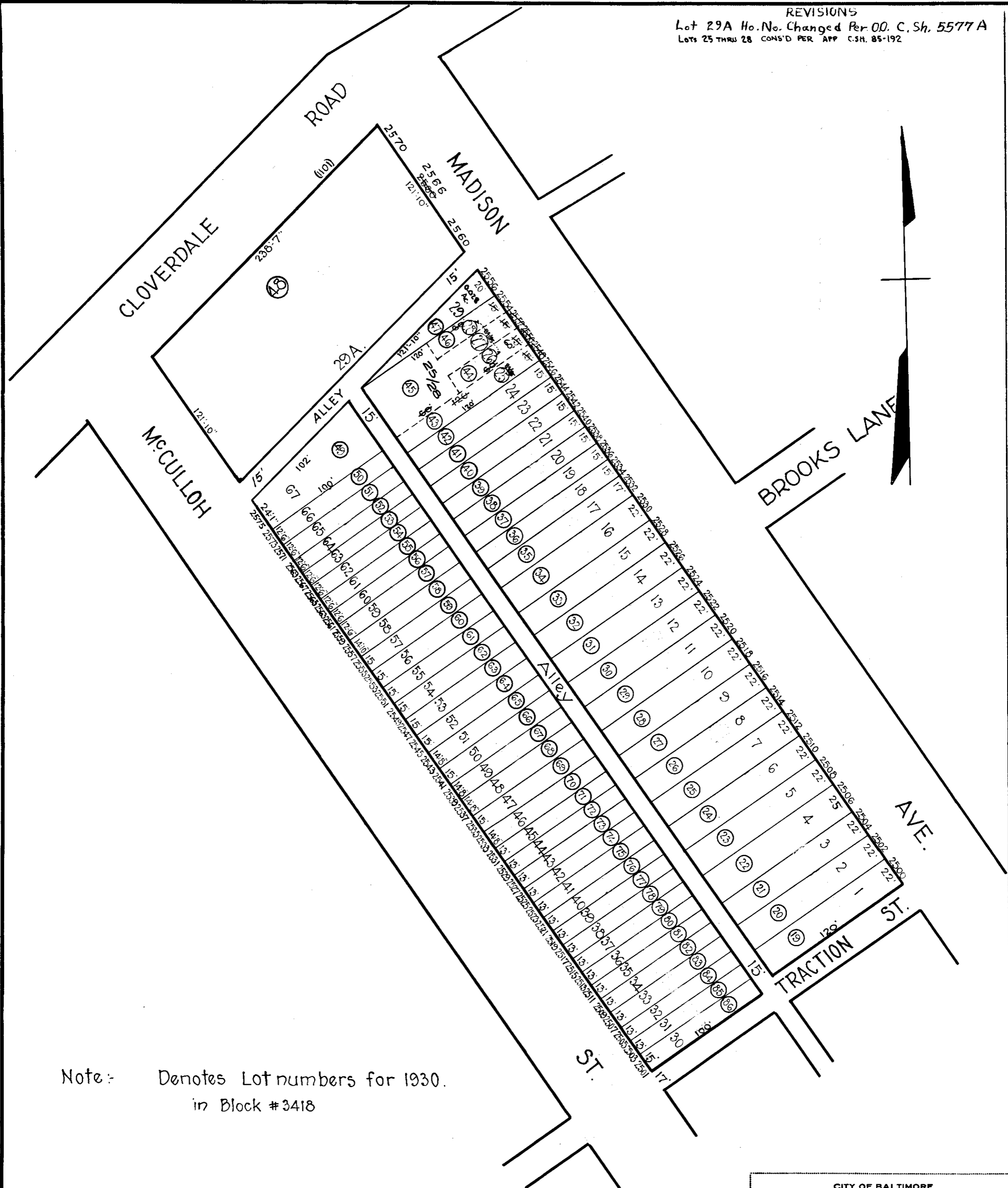

Note: Denotes Lot numbers for 1930.
 in Block #3418

TRACED BY C. H. BAIN
 LETTERED BY W. M. Lee
 CHECKED BY _____

NOTICE
 THIS IS A REAL PROPERTY PLAT AS PROVIDED
 FOR UNDER ARTICLE 76(4) OF THE CITY CHARTER
 IT IS COMPILED FROM TITLE AND OTHER
 SOURCES AND IS NOT AN AUTHENTIC SURVEY.

CITY OF BALTIMORE
 DEPARTMENT OF PUBLIC WORKS
 BUREAU OF PLANS & SURVEYS
 PROPERTY LOCATION DIVISION
 WARD **13** SECTION **8**
 BLOCK **3418-A**
 SCALE 1" = 60.0' DATE Dec. 1929