

REVISIONS

LOT 32/33 CONS'D PER O.O.C. SH 9588
 LOTS 27 & 28/29 PER DEED, C.S.H. 86-030
 LOTS 1-3, 8-12, 34, 34C, 34D, 34-56 & 70 PER DEED, C.S.H. 87-471-472
 LOTS 30 & 31 CONS'D PER O.O.C. SH 00-104

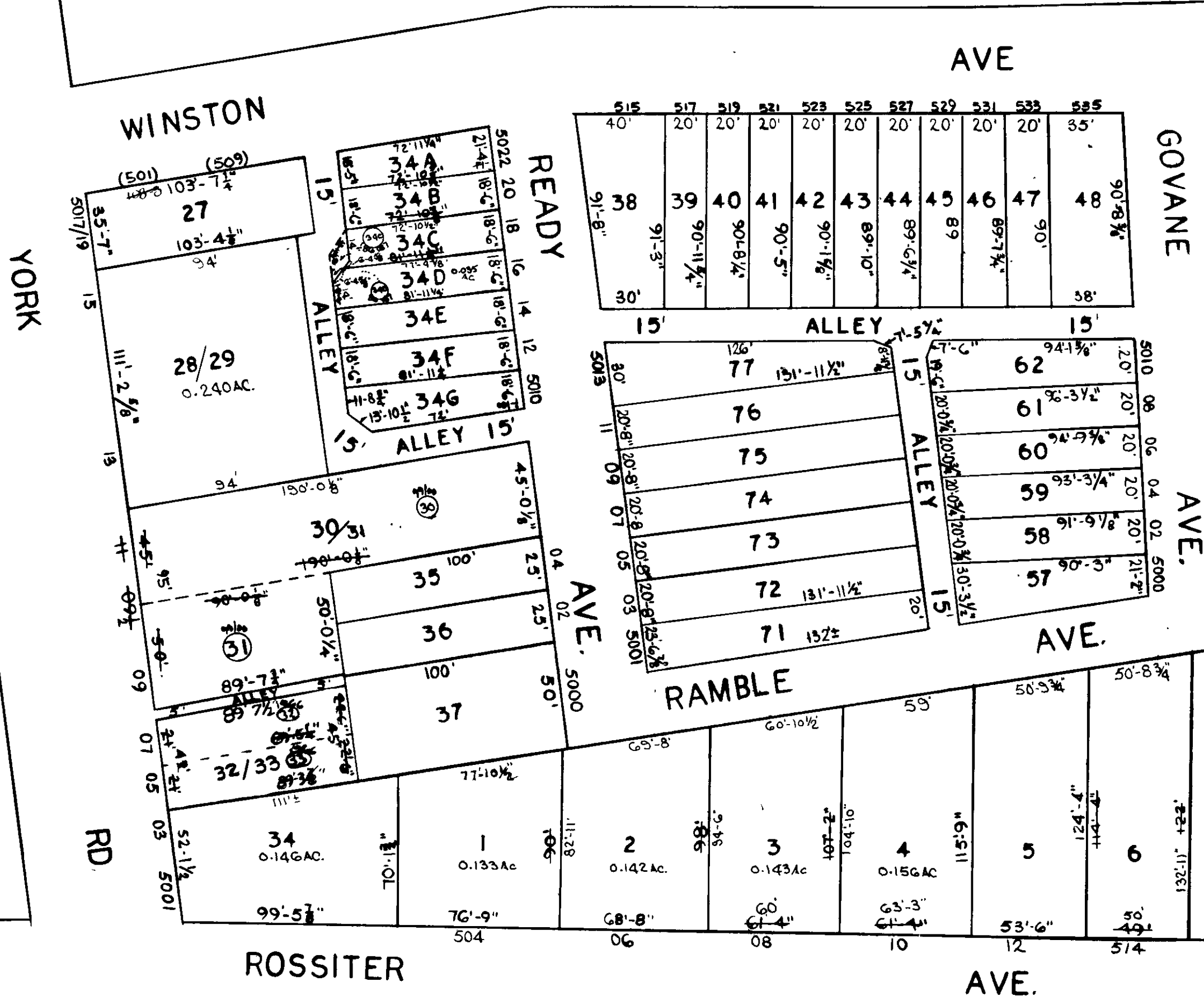

5173



5053D

SEE SHEET N42

5180

SHEETS IN SET 2
 SHEET NO. 1

TRACED BY LG
 LETTERED BY LG
 CHECKED BY

NOTICE
 THIS IS A REAL PROPERTY PLAT AS PROVIDED FOR UNDER ARTICLE 76(d) OF THE CITY CHARTER IT IS COMPILED FROM TITLE AND OTHER SOURCES AND IS NOT AN AUTHENTIC SURVEY.

CITY OF BALTIMORE
 DEPARTMENT OF PUBLIC WORKS
 PROPERTY LOCATION DIVISION
WARD 27 SECTION 47
BLOCK 5180A
 SCALE 1"=50' DATE MAR 1966