

REVISIONS

Lot 100 Desc. CHANGED PER P.S. C. SH 3089A.
 Lots 55/56, 62 & 63 Const'd. Per App. 1545, C. Sh. 4913.
 Lots 39 & 40 Const'd PER App. CH. SH. 80-442
 Lots 49 & 50 Const'd PER O.O. C. SH 07-204

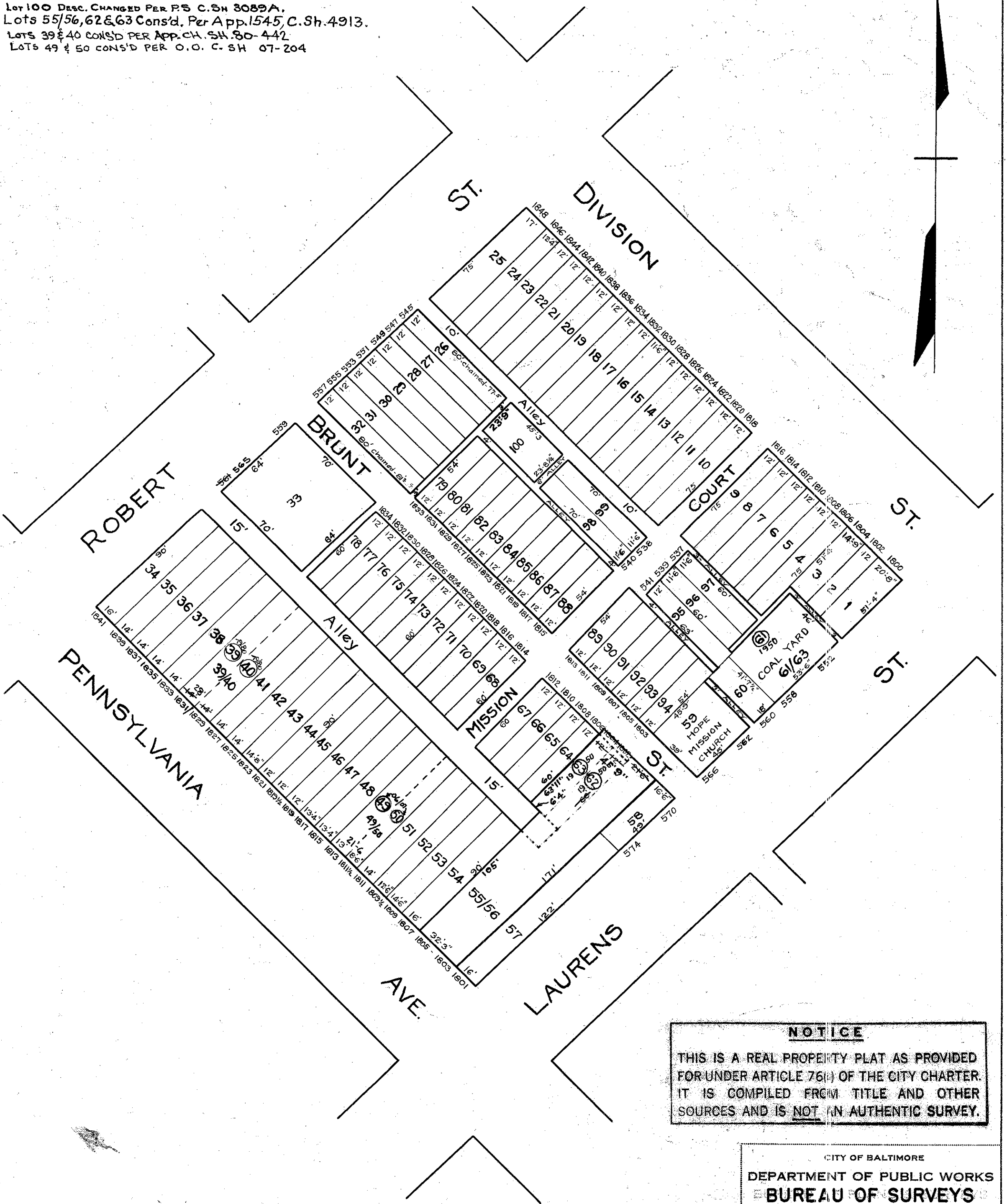

NOTICE
 THIS IS A REAL PROPERTY PLAT AS PROVIDED FOR UNDER ARTICLE 76(D) OF THE CITY CHARTER. IT IS COMPILED FROM TITLE AND OTHER SOURCES AND IS NOT AN AUTHENTIC SURVEY.

TRACED BY S.J. Moorhead
 LETTERED BY Moorhead
 CHECKED BY _____

CITY OF BALTIMORE
 DEPARTMENT OF PUBLIC WORKS
BUREAU OF SURVEYS
 PROPERTY LOCATION DIVISION
 WARD **14** SECTION **7**
 BLOCK **327**
 SCALE 1" = 50' DATE Oct. 1929