

REVISIONS

PLAT REVISED PER DEEDS CH. SH. 79-067
 LOTS 23 & 32 PER DEED, C. SH. 80-231
 LOTS 9, 11-12A DIM CHANGED PER DEED C. SH. 81-440
 LOT 9 NO. NO. PER. APP. C. SH. 82-097
 LOT 20/21 & 33 CONSD PER O.O. C. SH. 85-269
 LOTS 9, 12, 12A CONSD PER O.O. CH. SH. 95-032
 LOTS 14 & 19 DIV. & CONSD PER DEED & SUBDIV. CH. SH. 05-101

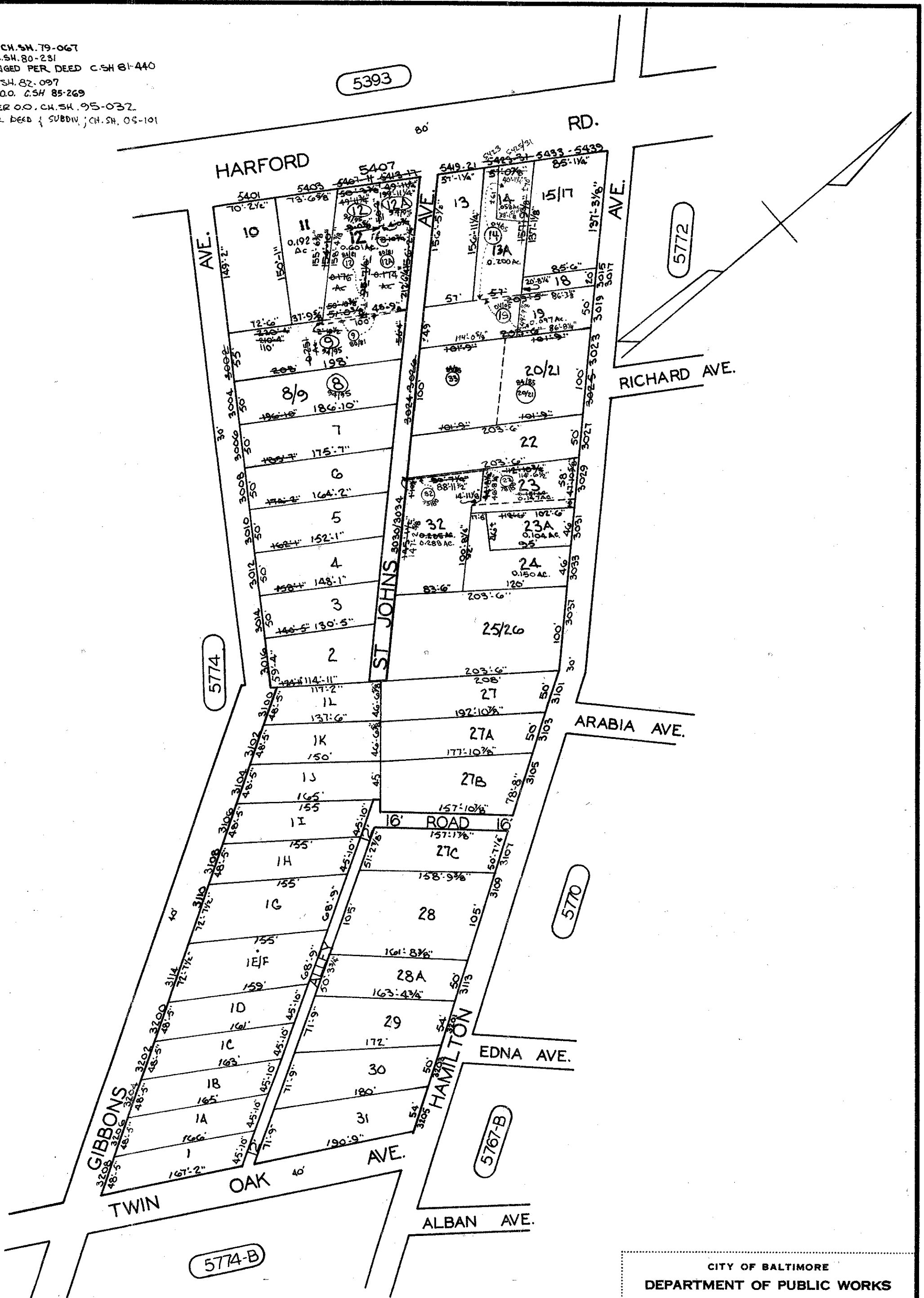

TRACED BY: *W.A. Beatty*
 LETTERED BY: *W.A. Beatty*
 CHECKED BY: _____

NOTICE
 THIS IS A REAL PROPERTY PLAT AS PROVIDED FOR UNDER ARTICLE 76(d) OF THE CITY CHARTER IT IS COMPILED FROM TITLE AND OTHER SOURCES AND IS NOT AN AUTHENTIC SURVEY.

CITY OF BALTIMORE
 DEPARTMENT OF PUBLIC WORKS
 PROPERTY LOCATION DIVISION
 WARD **27** SECTION **2**
 BLOCK **5774-A**
 SCALE: 1"=100' DATE: DECEMBER, 1978