

REVISIONS

LOT 85 CORRECTED PER DEED & FIELD C. SH 1522.
 Lot 101 Div Per Deed C. Sh 6186
 Lot 86/87 PER O.O. (Letter) C. Sh. 8821
 LOTS 66 & 67 CONS'D PER DEED C. SH. 242
 LOT 64/67 CONS'D PER APP. C. SH. 80-183
 LOTS 99 & 100 OWN'D PER O.O.; CH. SH. 11-007

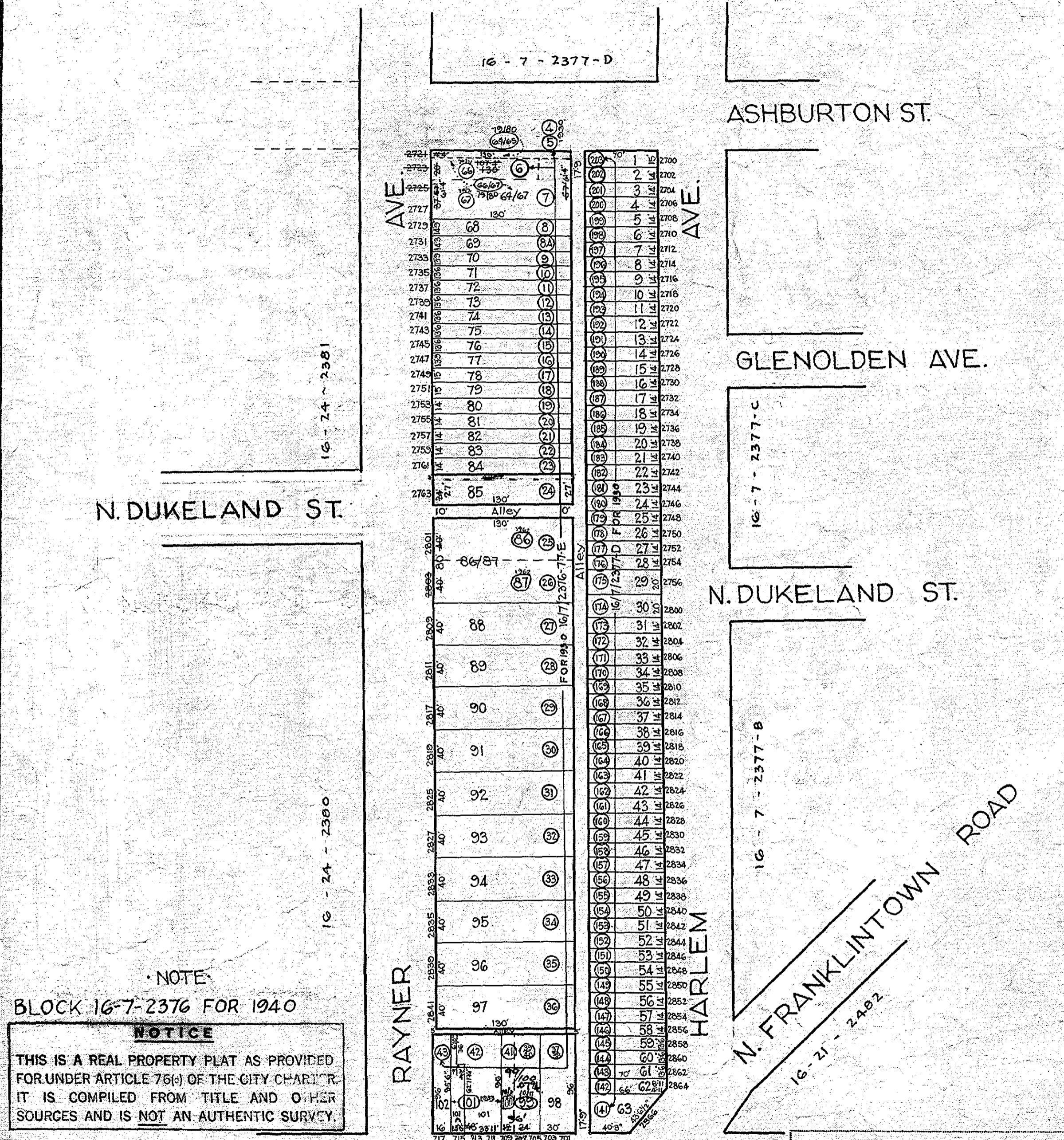
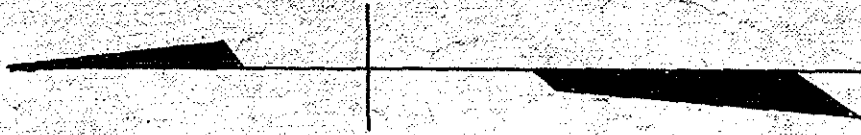

N. DUKELAND ST.

ASHBURTON ST.

GLENOLDEN AVE.

N. DUKELAND ST.

POPLAR GROVE ST.

NOTE
 BLOCK 16-7-2376 FOR 1940

NOTICE
 THIS IS A REAL PROPERTY PLAT AS PROVIDED FOR UNDER ARTICLE 76(a) OF THE CITY CHARTER. IT IS COMPILED FROM TITLE AND OTHER SOURCES AND IS NOT AN AUTHENTIC SURVEY.

TRACED BY J.H. Kilmore
 LETTERED BY Jos. J. Rekosky
 CHECKED BY _____

CITY OF BALTIMORE
 DEPARTMENT OF PUBLIC WORKS
 BUREAU OF PLANS & SURVEYS
 PROPERTY LOCATION DIVISION
 WARD 16 SECTION 7
 BLOCK 2377A
 SCALE 1" = 80 FT. DATE Feb. 1930