

REVISIONS

Dimensions per Field and Deed (Dec. 19, 1933)
 Lots 11 & 12 Div. PER D. OF LAW, C.S. 8999-9
 Lots 55 to 65 C.S. 9522
 Lots 15, 16, 17 CONS'D PER O.O. C.S. 99-219

10/10/98

HARLEM

AVE.

66

ST.

ST.

ST.

6'

6'

10/9/109

N. MOUNT

N. VINCENT

N. GILMOR

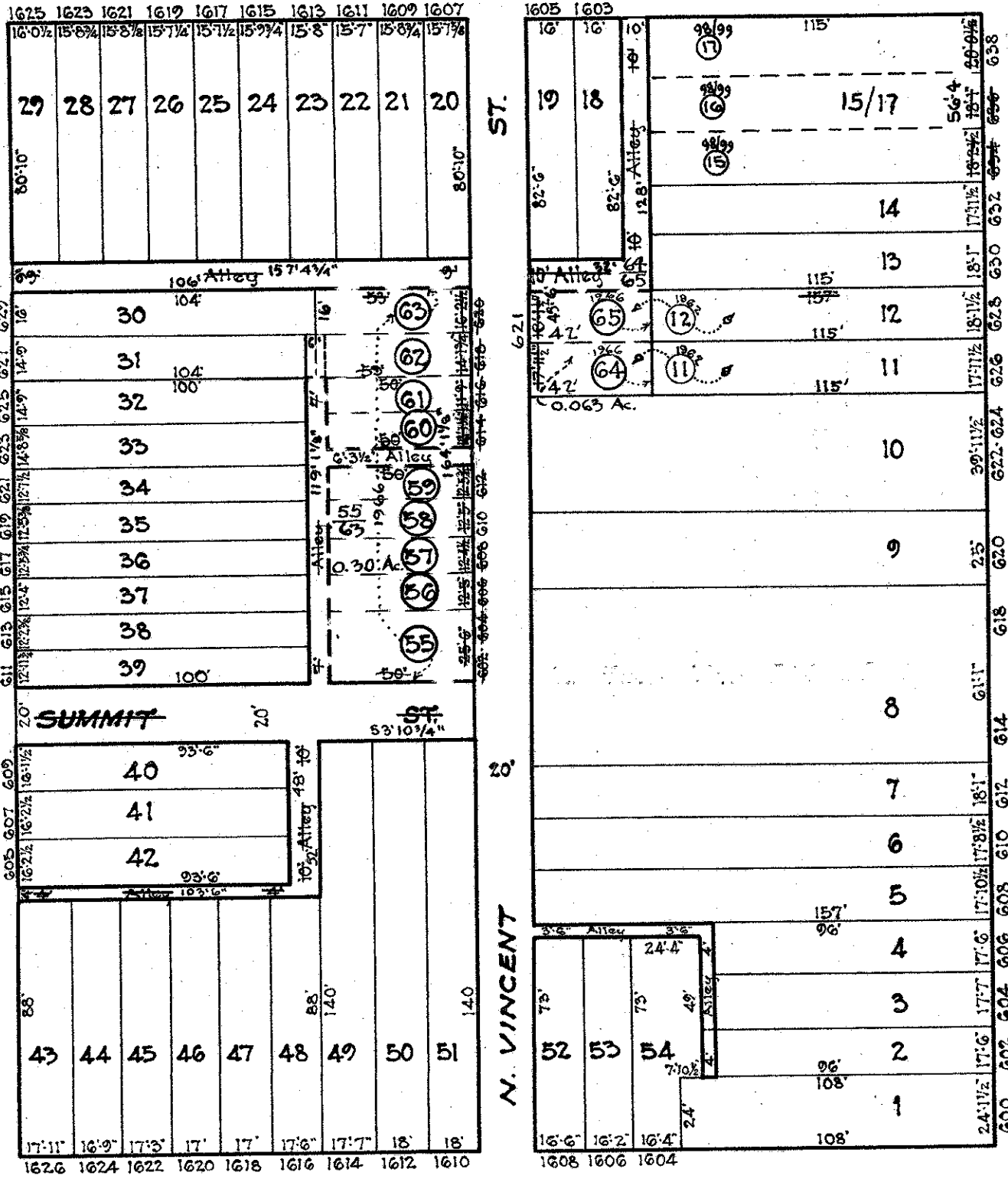

10/13/111

Park

Harlem

EDMONDSON

AVE.

66

10/2/122

NOTICE

THIS IS A REAL PROPERTY PLAT AS PROVIDED FOR UNDER ARTICLE 76(d) OF THE CITY CHARTER. IT IS COMPILED FROM TITLE AND OTHER SOURCES AND IS NOT AN AUTHENTIC SURVEY.

TRACED BY G.J. Moorehead
 LETTERED BY G.J. Moorehead
 CHECKED BY

CITY OF BALTIMORE
 DEPARTMENT OF PUBLIC WORKS
 BUREAU OF SURVEYS
 PROPERTY LOCATION DIVISION
 WARD 16 SECTION 9
 BLOCK 110
 SCALE 1" = 50'-0" DATE Dec. 1933