

REVISIONS

LOTS 1-23, 31-43, 46, 50-54 & 71-73 PER FIELD & DEED, C.S.H. 89-086 - 090
 LOTS 2 & 3 CONSD PER, O.O. C.S.H. 91-320
 LOTS 8 & 9 CONSD PER O.O. C.S.H. 99-039
 LOTS 8/9 10 & 11 CONSD PER O.O. C.S.H. 04-098
 LOTS 2/3 DIV. PER SUBDIV.; CH. SH. 19-051

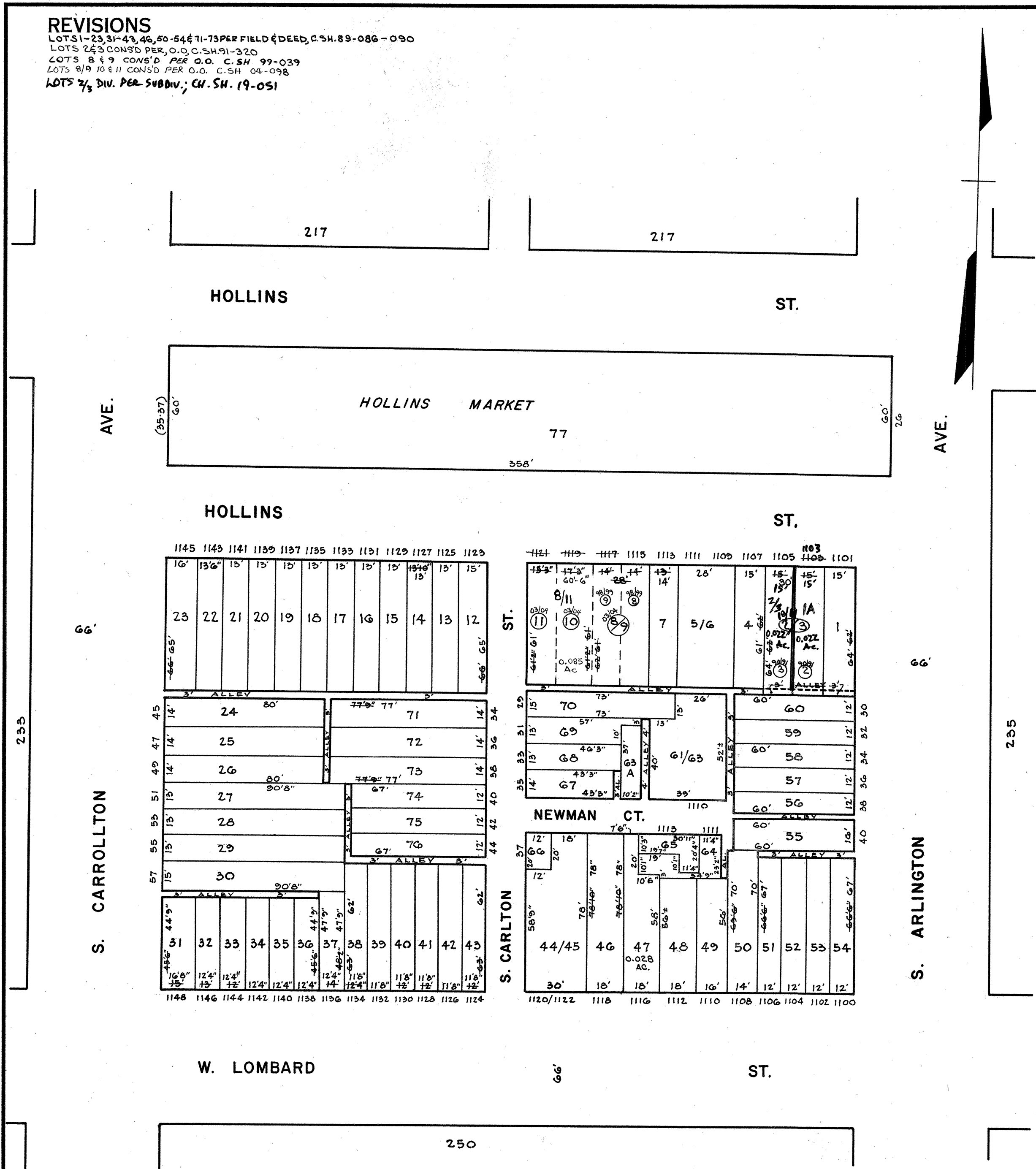

TRACED BY... P. BARNES
 LETTERED BY... P. BARNES
 CHECKED BY...

NOTICE
 THIS IS A REAL PROPERTY PLAT AS PROVIDED FOR UNDER ARTICLE 76(d) OF THE CITY CHARTER IT IS COMPILED FROM TITLE AND OTHER SOURCES AND IS NOT AN AUTHENTIC SURVEY.

CITY OF BALTIMORE
 DEPARTMENT OF PUBLIC WORKS
 PROPERTY LOCATION DIVISION
 WARD 18 SECTION 7
 BLOCK 234
 SCALE 1" = 40' DATE SEPT. 1988