

REVISIONS.

Block Changed, Per B of A, & P.S. C. Sh. 2929.

Lot 63 Divided Per Deed C. S. H. 8410.

Lot 65 Desc. Changed Per P.L.D. C. S. H. 8450A.

Lot 63A Div Per Deed C. S. H. 8853

Lots 63B & 64 Cons'd Per App. C. S. H. 689

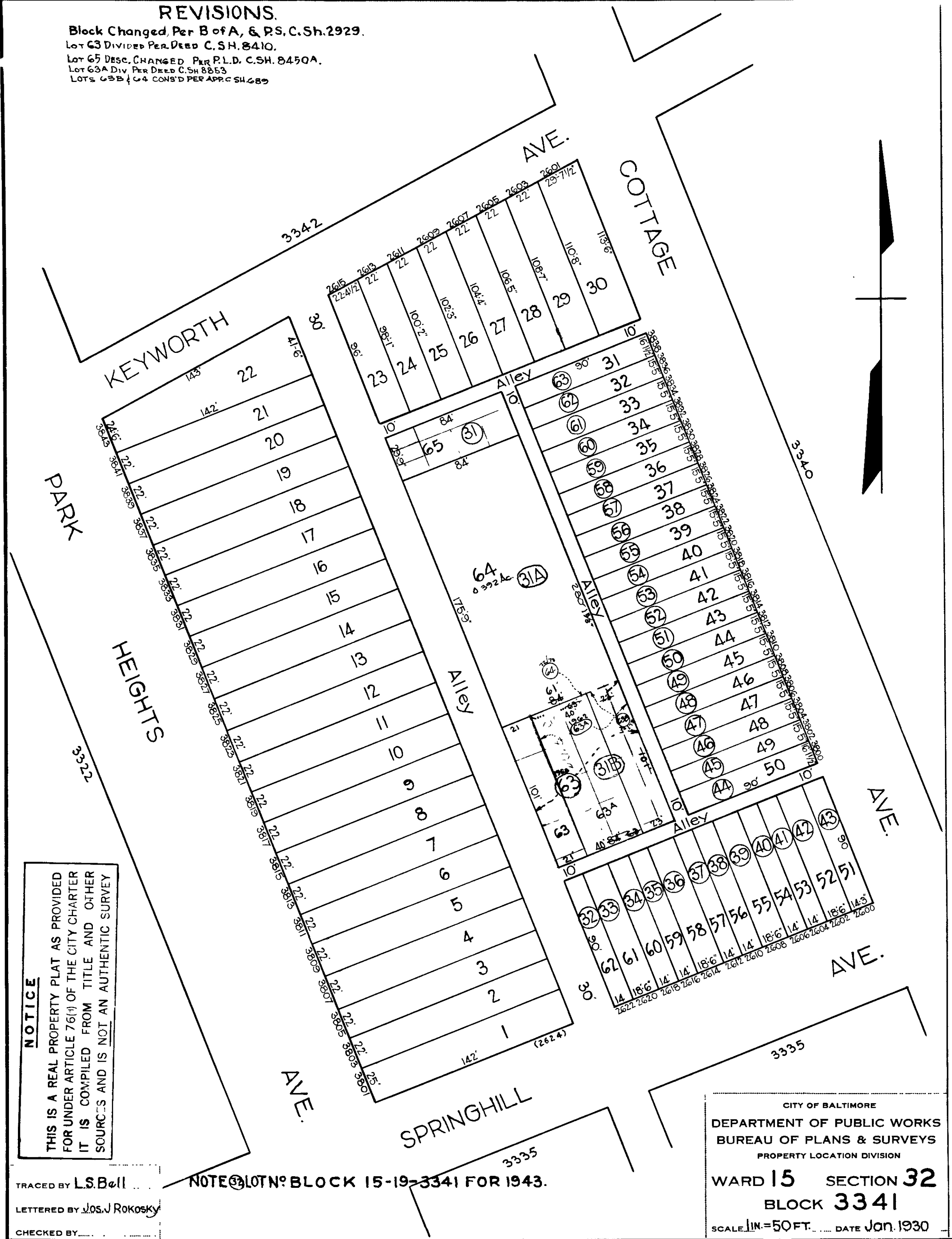

NOTICE

THIS IS A REAL PROPERTY PLAT AS PROVIDED FOR UNDER ARTICLE 76(F) OF THE CITY CHARTER. IT IS COMPILED FROM TITLE AND OTHER SOURCES AND IS NOT AN AUTHENTIC SURVEY.

TRACED BY L.S. Bell
 LETTERED BY JOS. J. ROKOSKY
 CHECKED BY

NOTE: LOT NO. BLOCK 15-19-3341 FOR 1943.

CITY OF BALTIMORE
 DEPARTMENT OF PUBLIC WORKS
 BUREAU OF PLANS & SURVEYS
 PROPERTY LOCATION DIVISION
 WARD 15 SECTION 32
 BLOCK 3341
 SCALE 1" = 50 FT. DATE Jan. 1930