

# REVISIONS

BLOCK CHANGED PER B.O.F.A. & P.S. C.S.H. 2929.  
 LOT 68 DIM. CORRECTED PER P.L.D. C.S.H. 8999-25,  
 LOTS 67 & 68 CONSID. PER APP. C.S.H. 690  
 LOTS 1 & 2 CONSID. PER O.O. C.S.H. 07-144

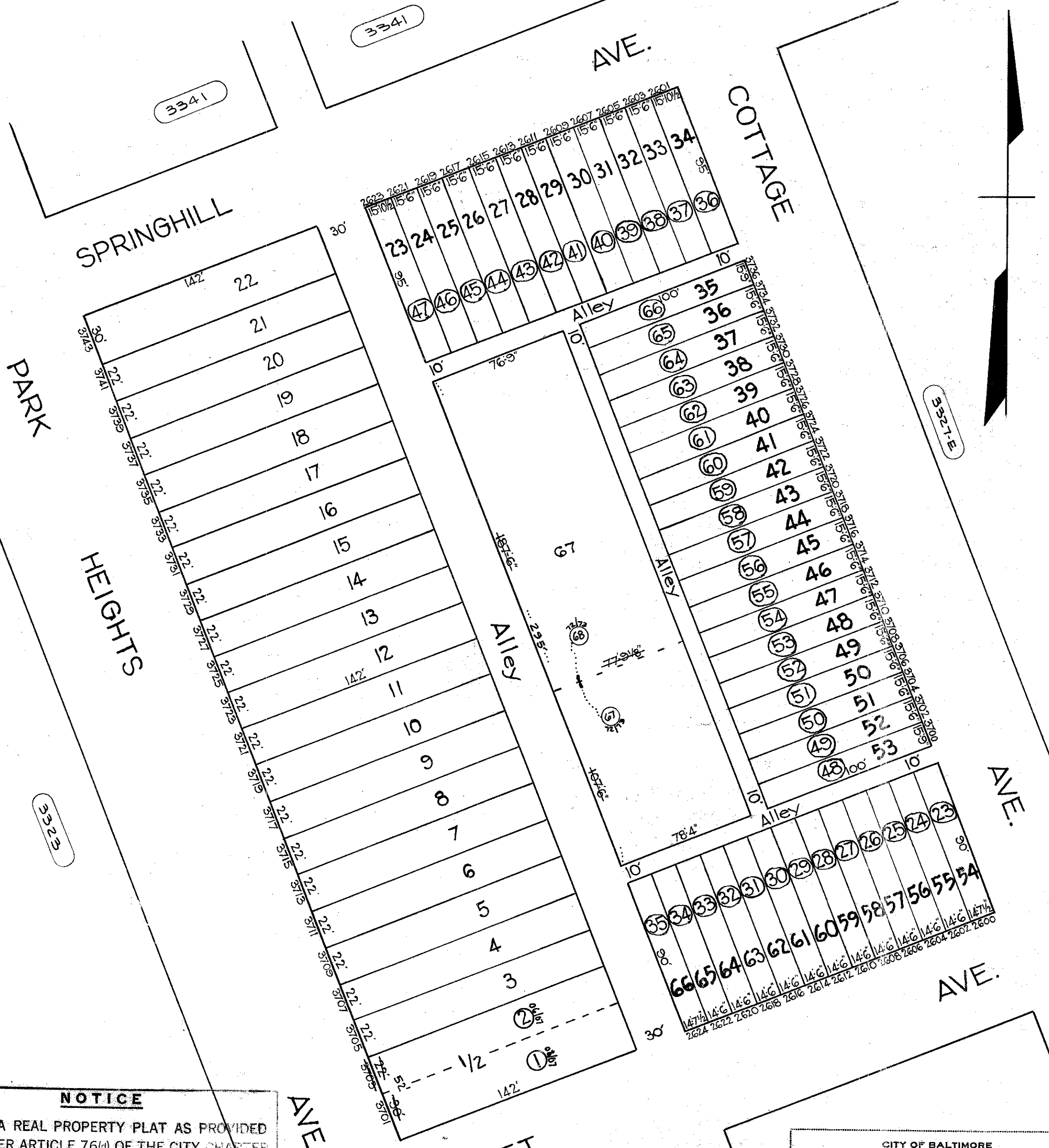

## NOTICE

THIS IS A REAL PROPERTY PLAT AS PROVIDED FOR UNDER ARTICLE 76(d) OF THE CITY CHARTER. IT IS COMPILED FROM TITLE AND OTHER SOURCES AND IS NOT AN AUTHENTIC SURVEY.

TRACED BY L.S. Bell

LETTERED BY Jos. J. Rokosky

CHECKED BY \_\_\_\_\_

NOTE: LOT N° BLOCK 15-19-3335 FOR 1943.

CITY OF BALTIMORE  
 DEPARTMENT OF PUBLIC WORKS  
 BUREAU OF PLANS & SURVEYS  
 PROPERTY LOCATION DIVISION

WARD 15 SECTION 32  
 BLOCK 3335

SCALE 1" = 50 FT. DATE Jan. 1930

3327-A