

REVISIONS
 LOT 51/52 PER APP. C. SH. 9377/9378
 LOT 37 DIM CHANGED PER DEED C SH 79-102

110

EDMONDSON AVE.

ST.

ST.

AVE.

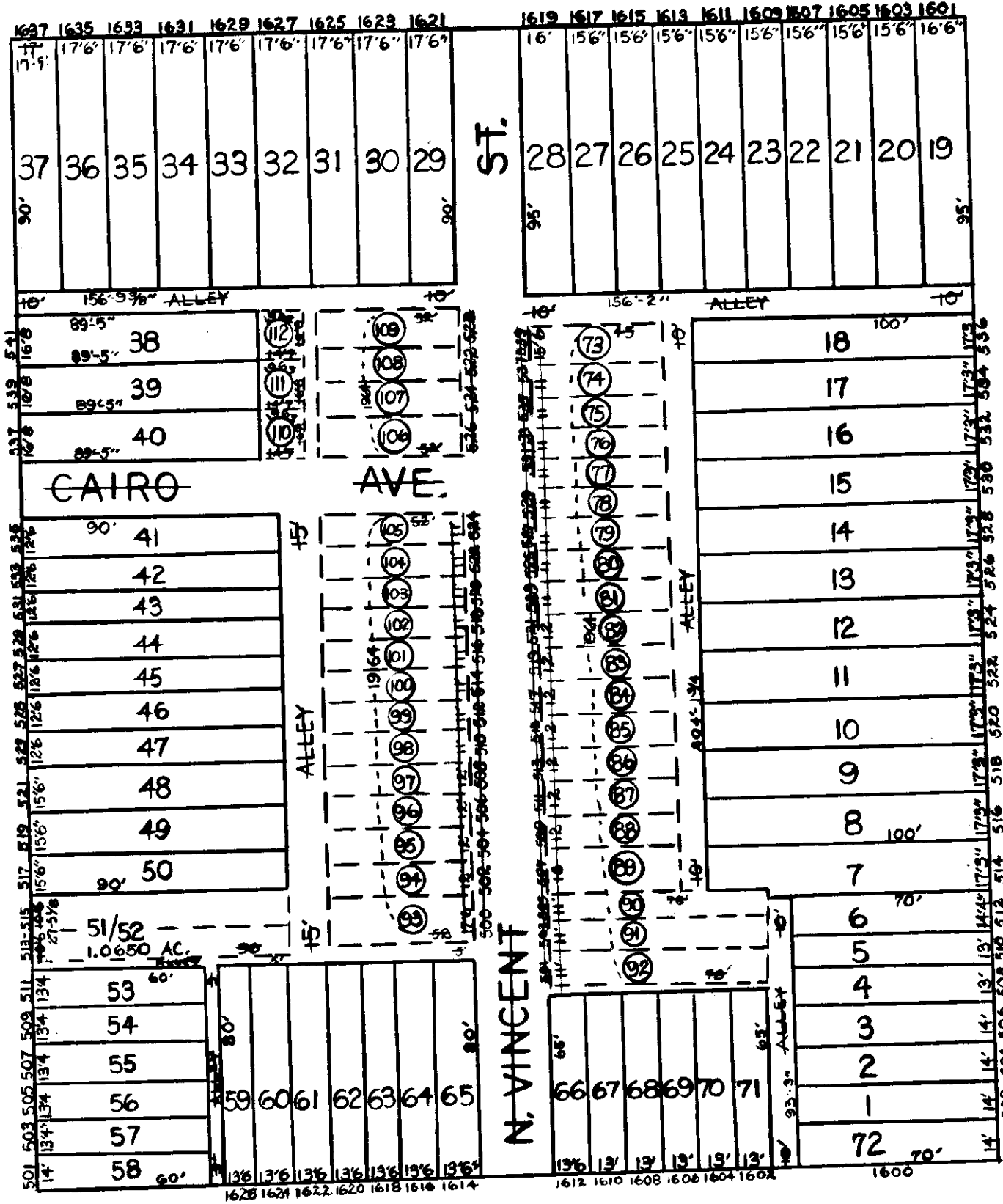

121

123

N. MOUNT

N. VINCENT

N. GILMOR

W. FRANKLIN

ST.

NOW BED OF I-170
 135

TRACED BY P.W.
 LETTERED BY P. WAINWRIGHT
 CHECKED BY

NOTICE
 THIS IS A REAL PROPERTY PLAT AS PROVIDED FOR UNDER ARTICLE 76(d) OF THE CITY CHARTER IT IS COMPILED FROM TITLE AND OTHER SOURCES AND IS NOT AN AUTHENTIC SURVEY.

CITY OF BALTIMORE
 DEPARTMENT OF PUBLIC WORKS

PROPERTY LOCATION DIVISION
 WARD 19 SECTION 2
 BLOCK 122

SCALE 1"=50'-0" DATE MAY 1966