

REVISIONS.

FRONT LOT 62 CORRECTED PER DEED & FIELD C.S.H. 2176 D.  
 LOTS 7 & 106 PER DEED & LOTS 41 & 44 PER P.L.D., C.S.H. 8873  
 Lot 70 - Field Book corrected PER PLS, C.S.H. 9911

W. NORTH

AVE.

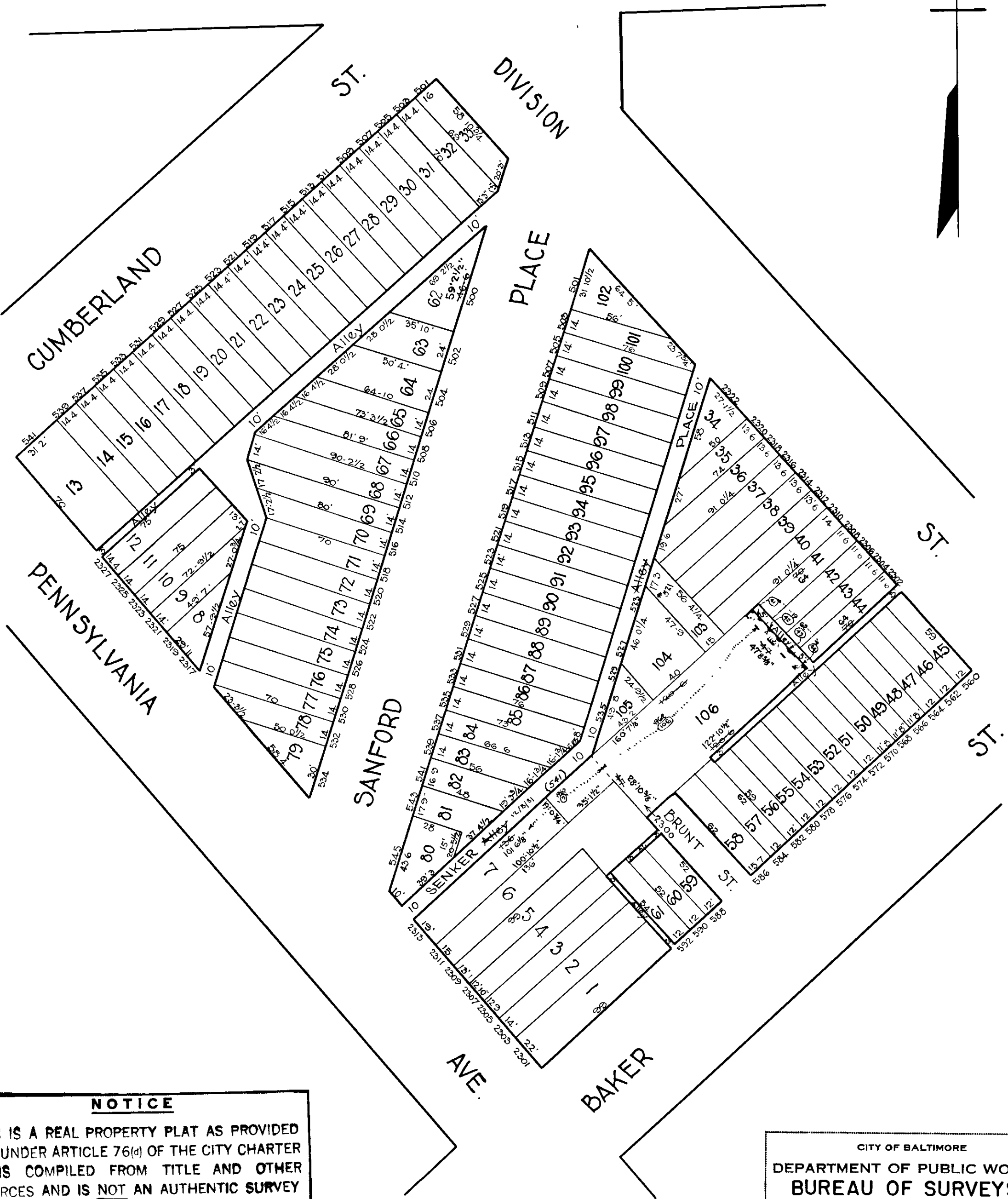
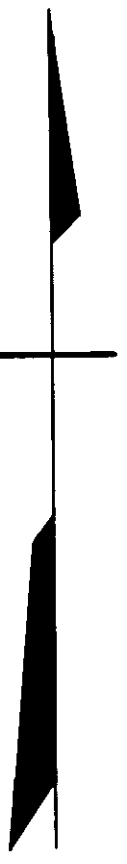

**NOTICE**  
 THIS IS A REAL PROPERTY PLAT AS PROVIDED FOR UNDER ARTICLE 76(d) OF THE CITY CHARTER IT IS COMPILED FROM TITLE AND OTHER SOURCES AND IS NOT AN AUTHENTIC SURVEY

TRACED BY G. Moorehead  
 LETTERED BY W. M. Lee  
 CHECKED BY

CITY OF BALTIMORE  
 DEPARTMENT OF PUBLIC WORKS  
 BUREAU OF SURVEYS  
 PROPERTY LOCATION DIVISION  
 WARD 14 SECTION 5  
 BLOCK 298  
 SCALE 1" = 50' 0" DATE July 1929