

REVISIONS  
 Div. Lots 1E-J per App. 514 C Sh. 831. 7-10-34.  
 Lots 19-23 & 70 per App. 2543, 10-16-36, C Sh. 1270.  
 " 70 per Deed. C Sh. 1390.  
 " 69-71/90, 91 per Deed, C Sh. 1493  
 Lot 4 DIVIDED PER DEED C. SH 1607. & APP 2626.  
 " 71/77, 78, 79/90 per Deed, C. Sh 1608.  
 Pt 49/50 to 47/48 Per App 4398 & DEED C. Sh. 2144.  
 Lot 49/50 Divided Per. Deed 6076/413 C. Sh. 2167  
**Lot 50 DIVIDED PER DEED & OWNERS ATTY C. SH 3830.**  
 Pt. Lot 71/77 Divided Per Deed & B.S.C. Sh. 4043.  
 Lot 49A Divided Per Deed, C. Sh. 4460.  
 Lot 50 Ho No Ass'd PLD C. Sh 5438 A  
 Lot 49B Ho No Ass'd PLD C. Sh 5457C  
 Lots 11 & 12 Cons'd. Per App. 1064, C. Sh. 6006  
 Lot 49A Ho No. Per P.L. D. C. Sh. 6320A.  
 Lot 79/90 Div. Per Deed C. Sh. 7034  
 Lots 92 to 96, 98 to 100 # 71, 72 Per Deeds, C. Sh. 7095  
 Lots 73 to 77 Per P.L.D. C. Sh. 7118

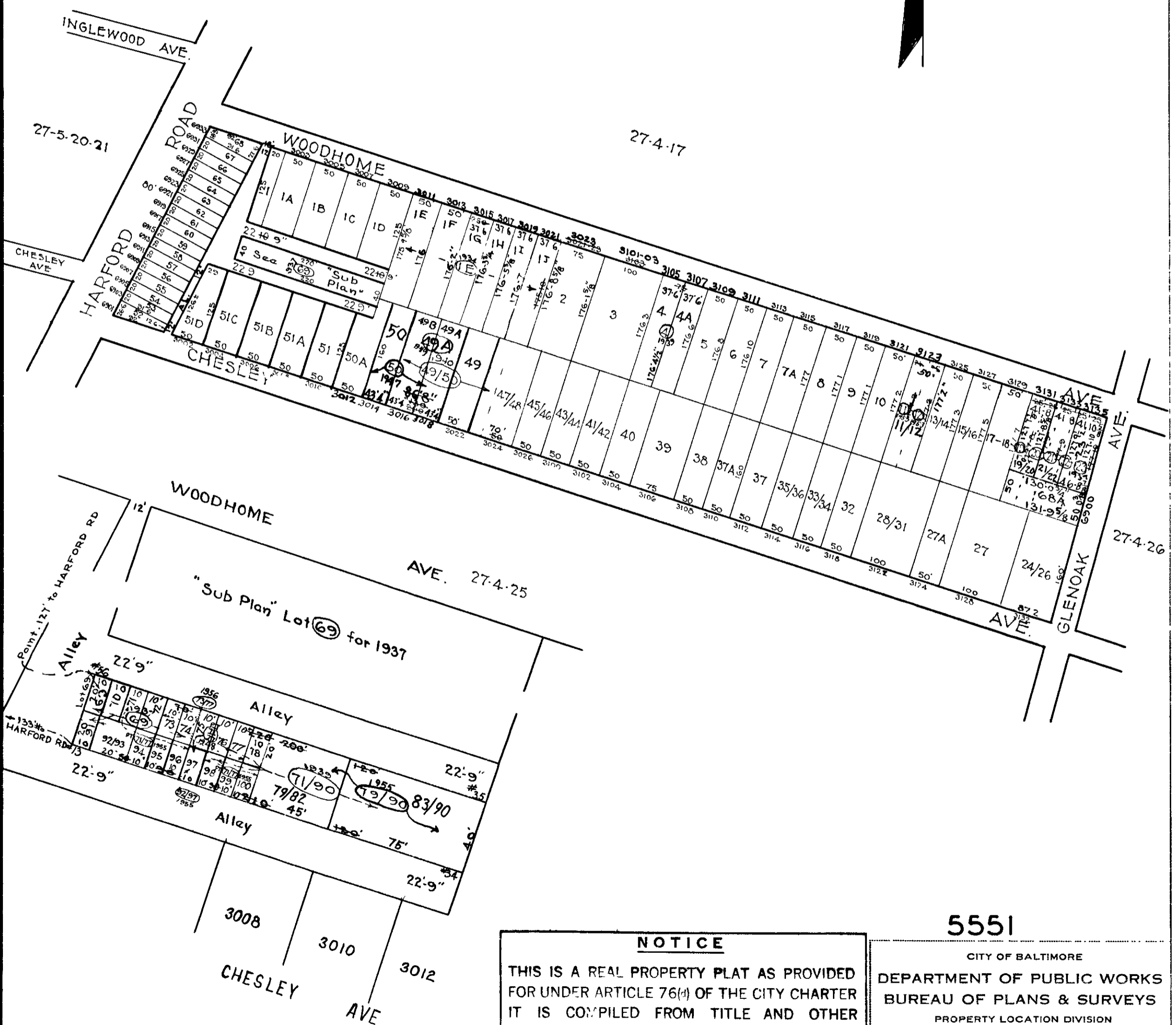
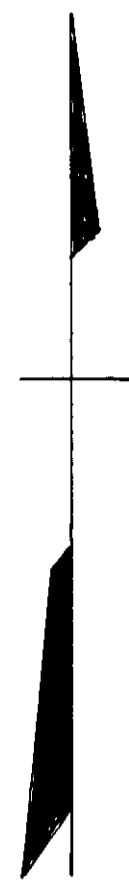

TRACED BY C. BAIN  
 LETTERED BY W. M. L.  
 CHECKED BY \_\_\_\_\_

**NOTICE**  
 THIS IS A REAL PROPERTY PLAT AS PROVIDED FOR UNDER ARTICLE 76(d) OF THE CITY CHARTER IT IS COMPILED FROM TITLE AND OTHER SOURCES AND IS NOT AN AUTHENTIC SURVEY.

NOTE - BLOCK 27-4-24 FOR 1941

**5551**  
 CITY OF BALTIMORE  
 DEPARTMENT OF PUBLIC WORKS  
 BUREAU OF PLANS & SURVEYS  
 PROPERTY LOCATION DIVISION  
 WARD **27** SECTION **4**  
 BLOCK **5551**  
 SCALE 1" = 150.0' DATE July 1931